



# CIRCUS AND THE CITY

**STUDIO HEIDELBERG**  
URBAN DESIGN COURSE FALL 2018





AAR4515 - URBAN DESIGN AND ARCHITECTURE  
**FALL SEMESTER 2018**

NTNU IAP CHAIR OF ARCHITECTURE & URBAN DESIGN  
PROF. KERSTIN HÖGER

**TEAM**

METTE SOFIE ANDREASSEN  
FRIEDERIKE DREWES  
DRIES VOUNCKX  
SONDRE KOLÅS KNUTSEN





# TABLE OF CONTENTS

HOW THE PROJECT IS BUILD UP

p 6 - 11	SITE & THE CITY
p 12 - 17	APPROACH
p 18 - 25	STRENGTHEN - CONNECT
p 26 - 65	ACT
p 66 - 77	GROW
p 78 - 83	MODELS





# SITE & THE CITY

BACKGROUND INFORMATION AND NECESSARY FACTS ABOUT OUR SITE

SITE IN HEIDELBERG





THREE DISTRICTS

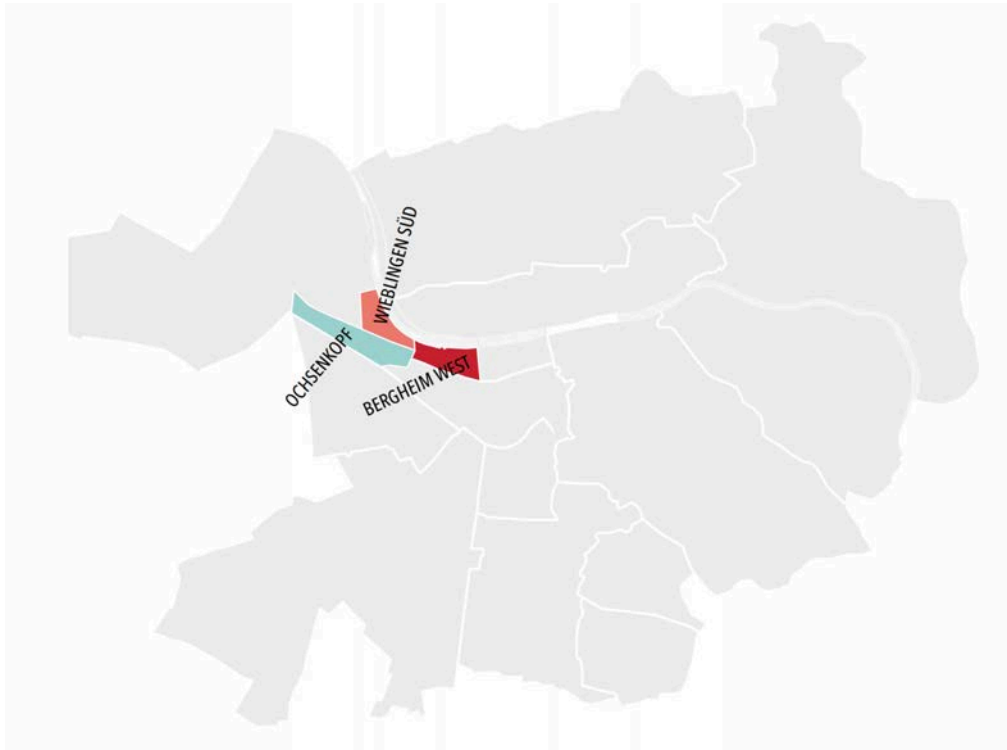

MOBILITY CONCEPT

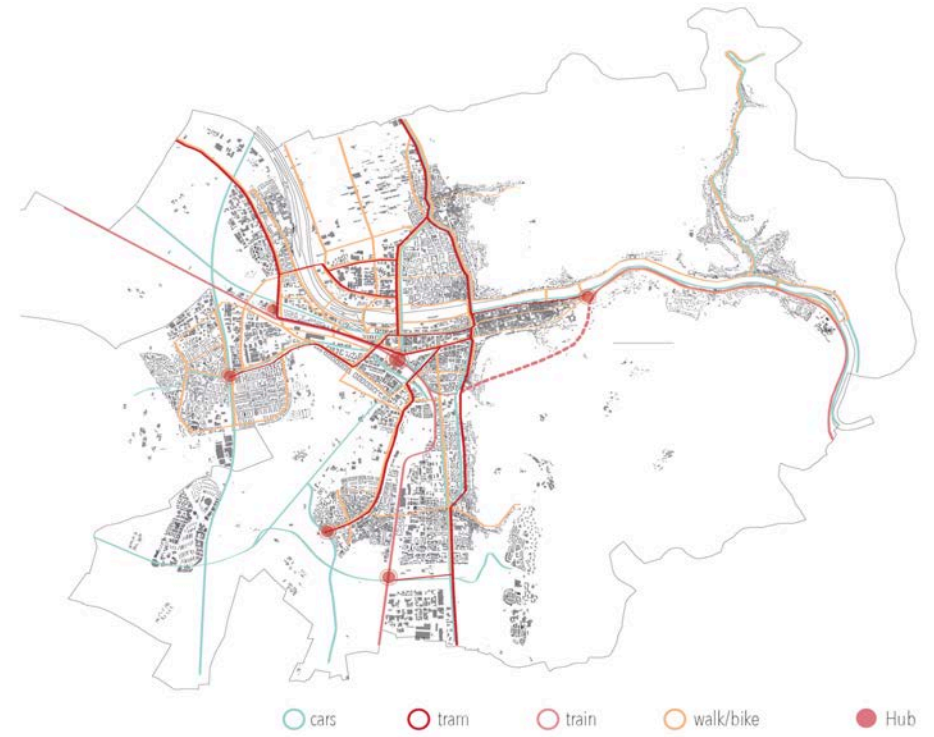

CHARACTERISTIC AREAS HEIDELBERG

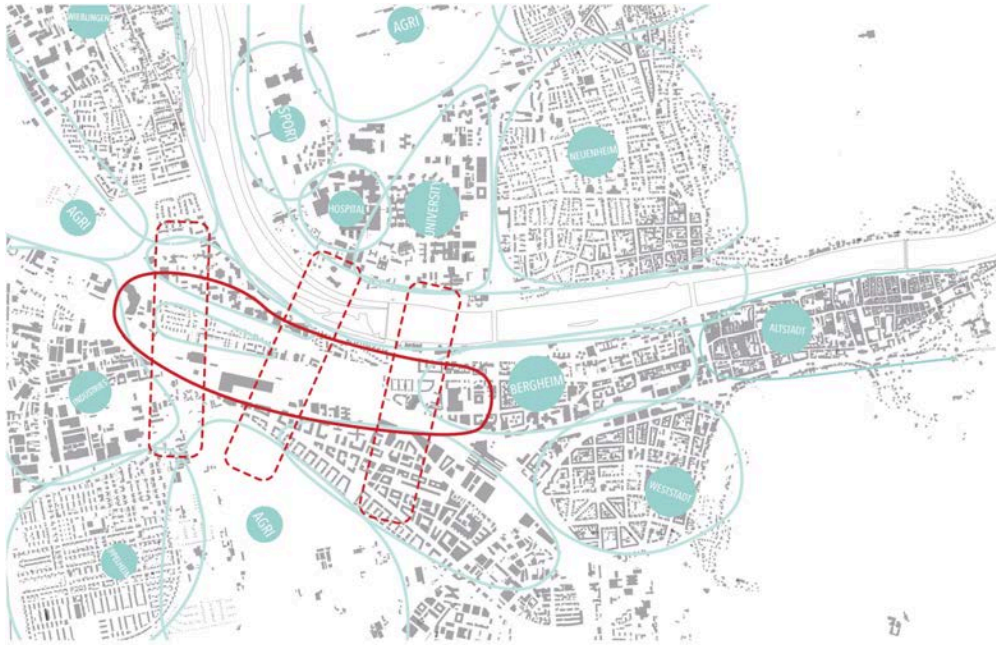

ISLANDS OF CHARACTER

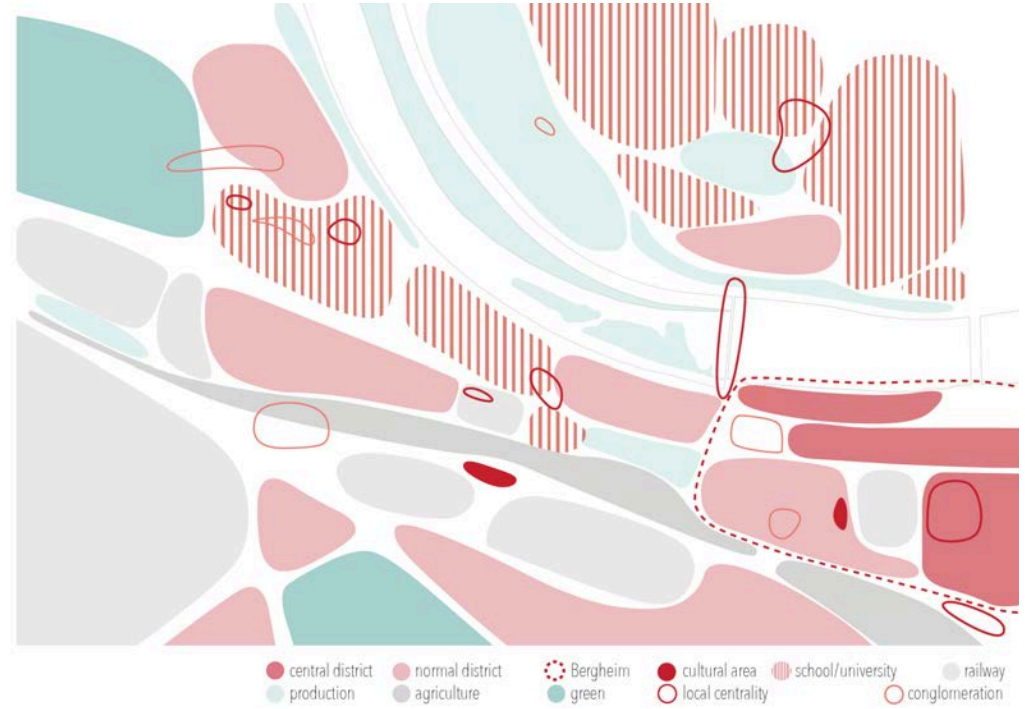

## BORDERS AND DISCONNECTIONS

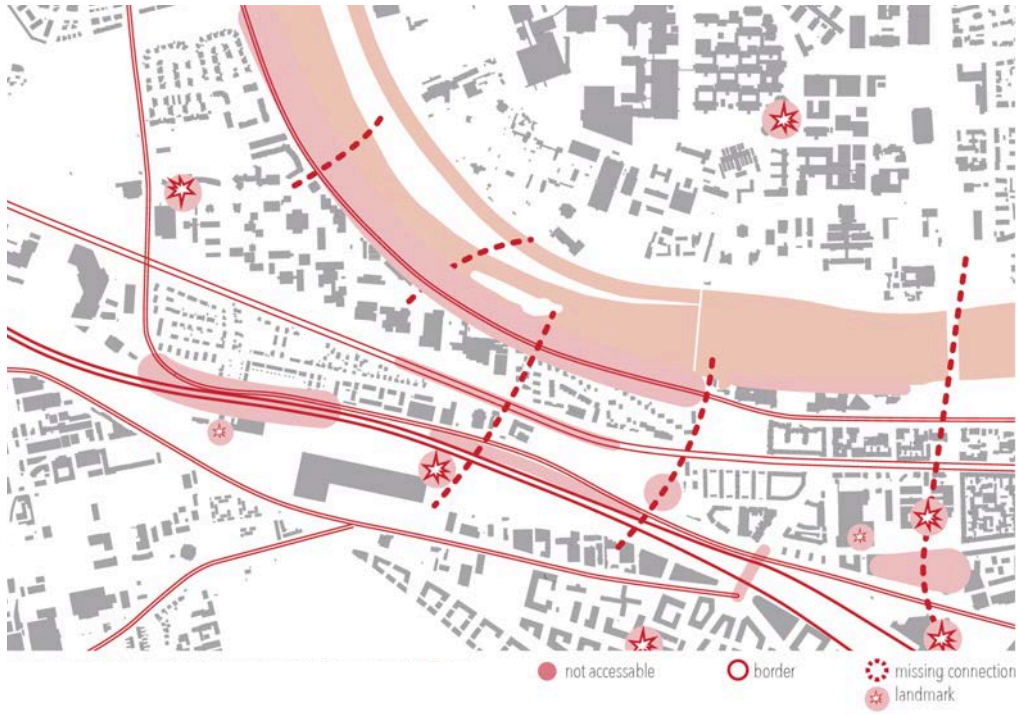

## FINDING THE HUMAN SCALE

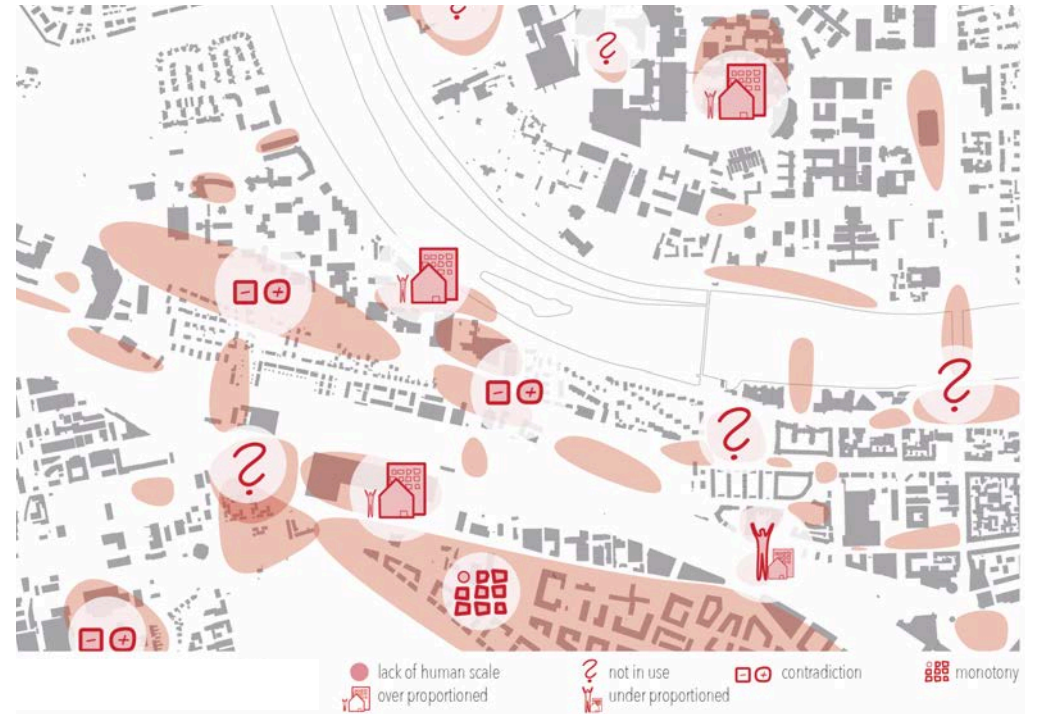





# APPROACH

DEVELOPMENT OF CONCEPTS AND STRATEGIES



Cities are expanding worldwide, and we are building like never before. With more and more people living in cities, the parameters of urban design are booming, making the complexity of traditional city planning harder to comprehend than ever. This project addresses these issues by presenting another way of handling city expansion and urban design. Our strategy for interaction can be summarized in four words: STRENGTHEN, CONNECT, ACT and GROW.

STRENGTHEN



First, we must address the mobility and infrastructure of the city. Strengthening the existing connections between east and west shortens the distance between Wieblingen, the SRH campus, and the city centre and Altstadt. Elevating the existing highway to ground level, turning it into a city boulevard, makes better room for improved north-south connections.

CONNECT



Using three main connections, we manage to link the two universities on either side of the Neckar, rehabilitating the existing bridge to become a more scenic bridge, which connects from Neuenheimer Feld all the way to Bahnhofstadt.

ACT



We then develop six urban acts, or catalysts, each bringing character and new aspects of city life to different areas of the site. These six acts will respond to the users, allowing them to evolve and lay the foundation for further growth in the area.

GROW



Our goal is to develop the city in a way that makes people care. We need better involvement from the inhabitants of the city. Done right, this form of development will ensure a more sustainable and organic city, where the citizens and their lives are at the centre of attention.





In order to assure this quality of development, we have created an non-profit organization known as the CIRCUS. This is a travelling circus of urban development, moving from site to site both in Heidelberg and other cities, engaging the citizens to find new interest and involvement in a better future for their hometown.

ENABLE



WHO?  
The government and property owners

HOW?  
Make plots available to temporary use and further development.

INITIATE



WHO?  
The circus, with citizens and other agents

HOW?  
Make agreements and legal resolutions with property owners, make foundations for users.

CLAIM



WHO?  
The citizens

HOW?  
Create new public spaces with social impulses free from commercial development. Spark interest and include marginalized groups.

COACH



WHO?  
The circus and the city

HOW?  
Link users and interest groups in supported networks. Increase public presence in city planning and development.

FORMALIZE



WHO?  
The government

HOW?  
Professionalize management and formalize the new development by legal regulations and permits.

EXPLOIT



WHO?  
Property owners

HOW?  
Use the public interest to keep development going, business growing and to make profit.





# STRENGTHEN & CONNECT

DESIGN AND RULES FOR THE MISSING LINKS

# STRENGTHEN I: DEALING WITH THE HIGHWAY

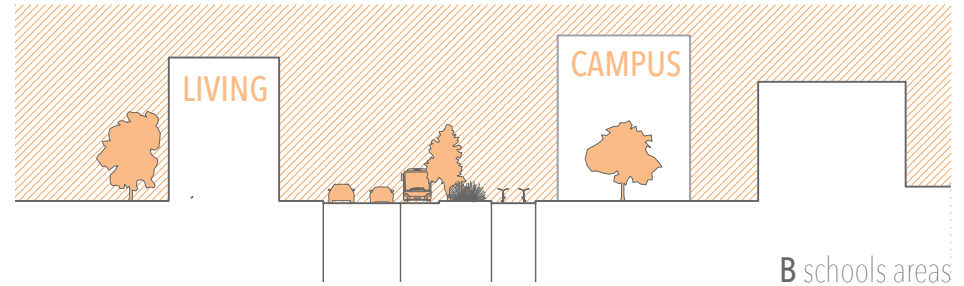
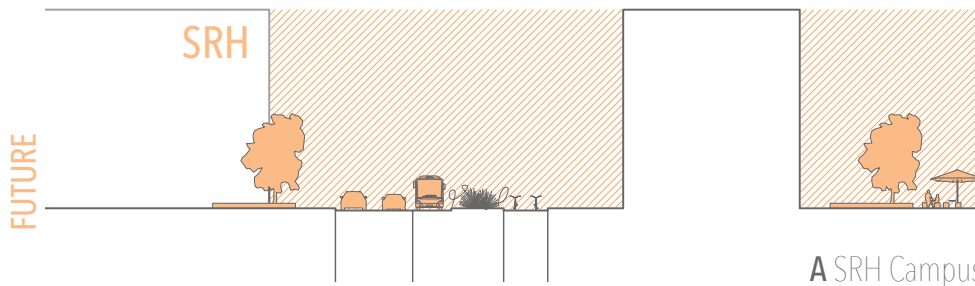
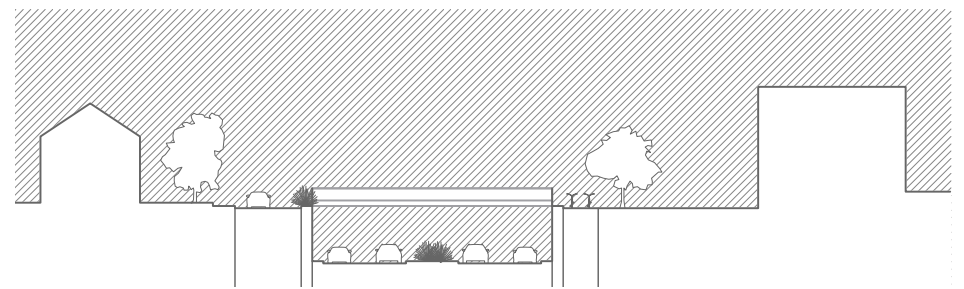
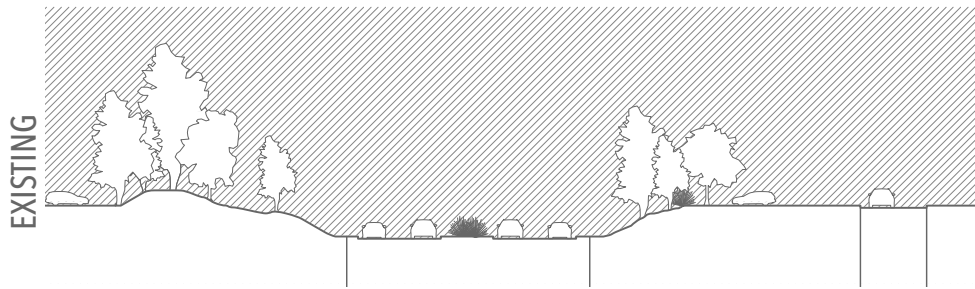
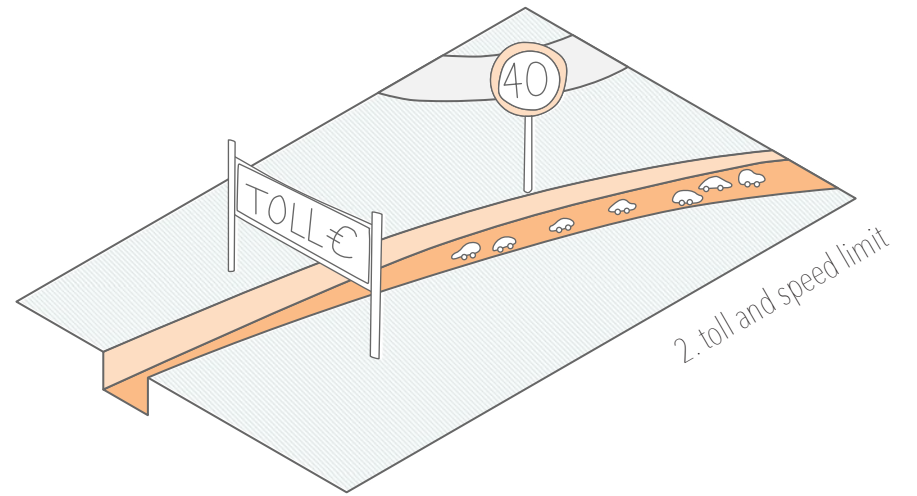
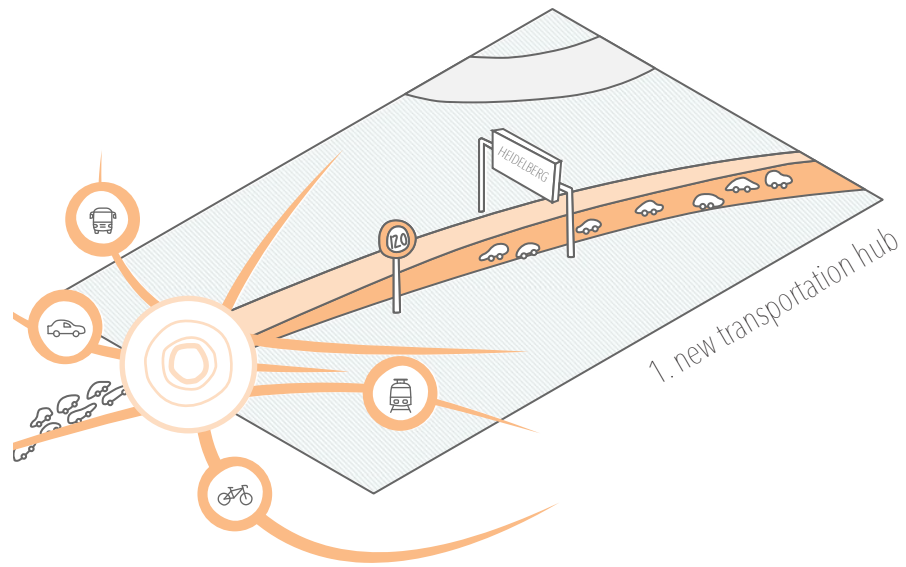

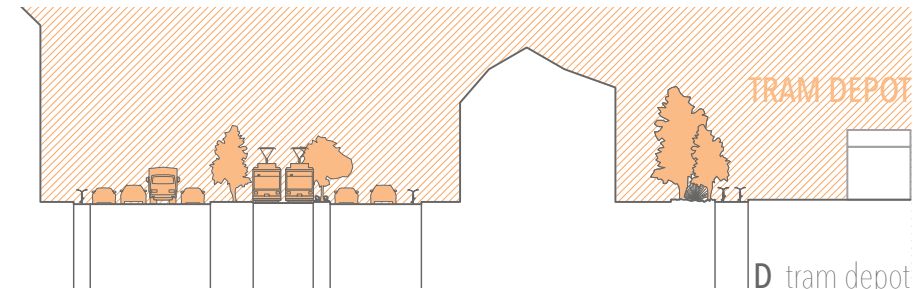
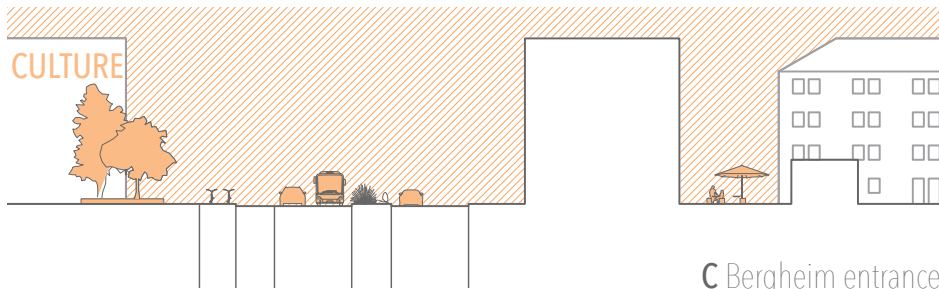
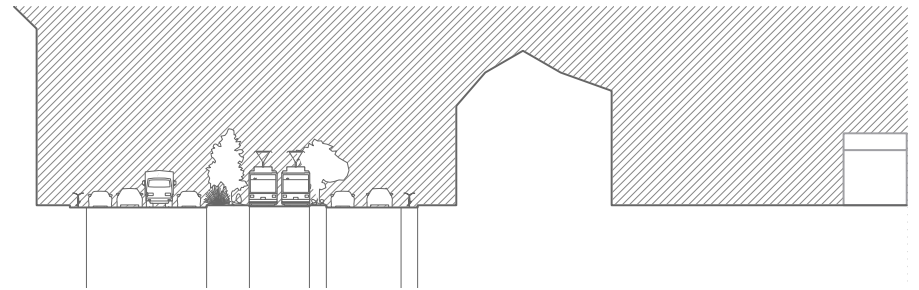
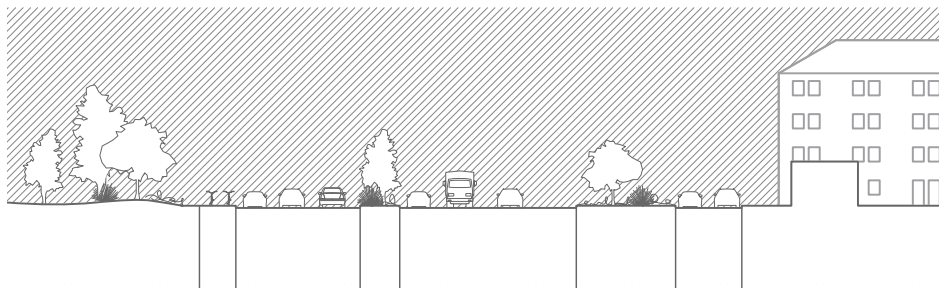
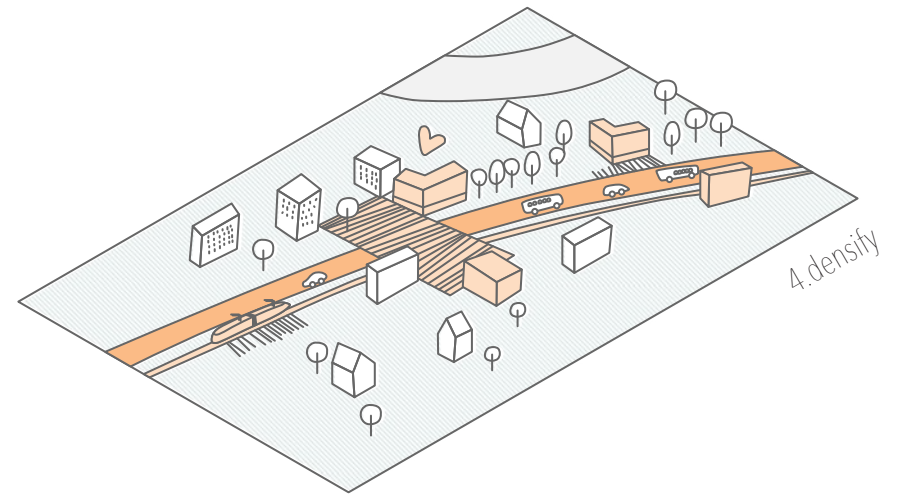
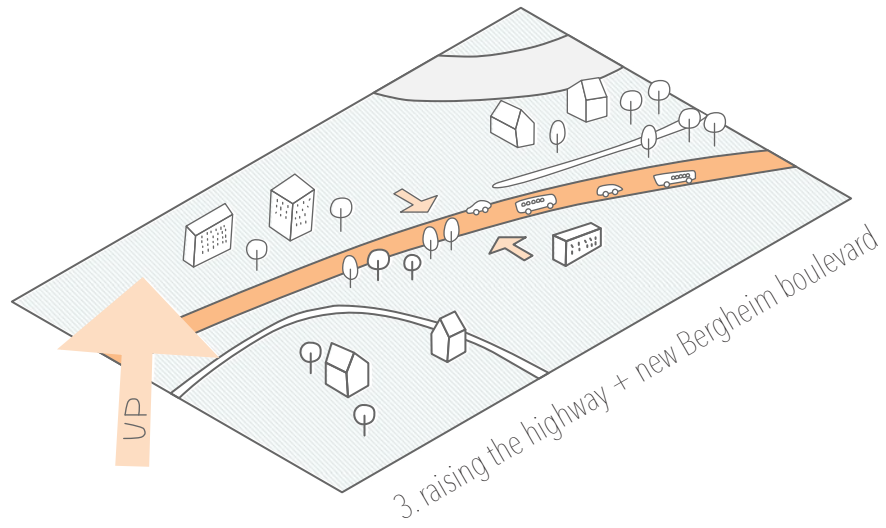

STRENGTHEN II: THE BIKE LANE

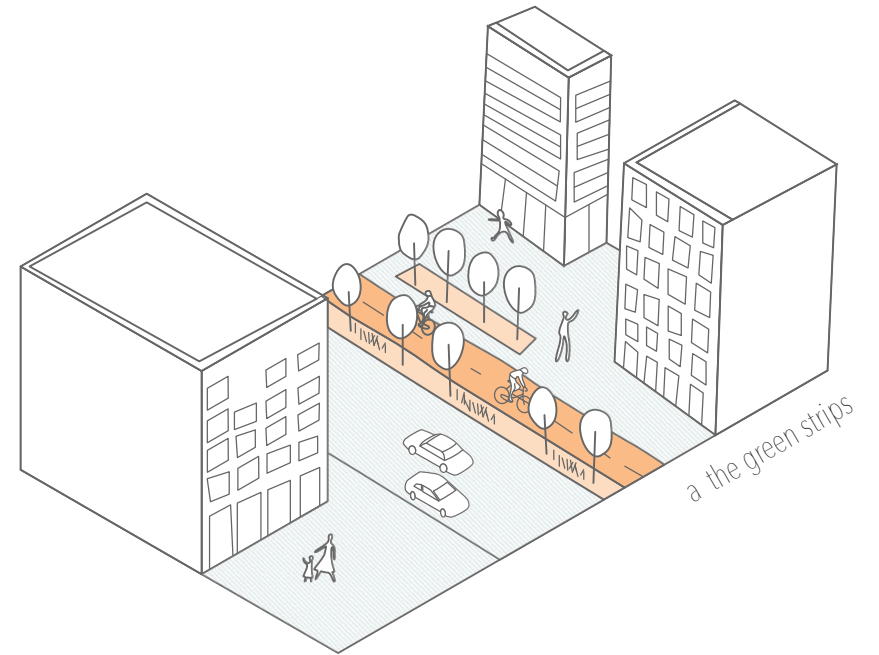
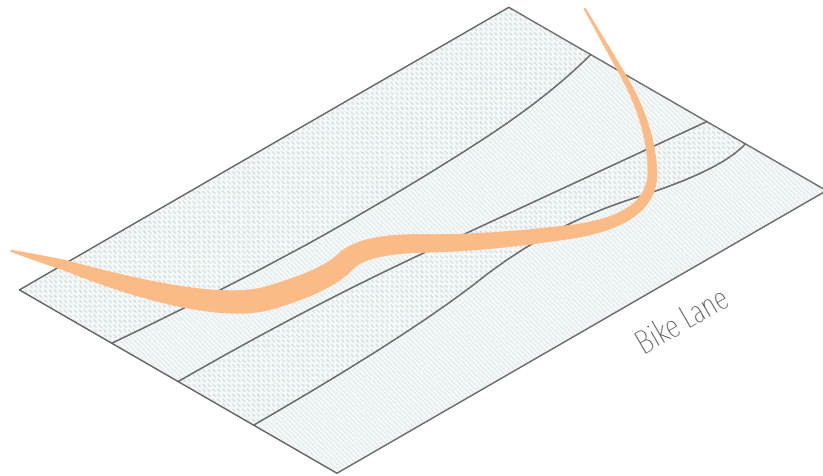

CONNECT

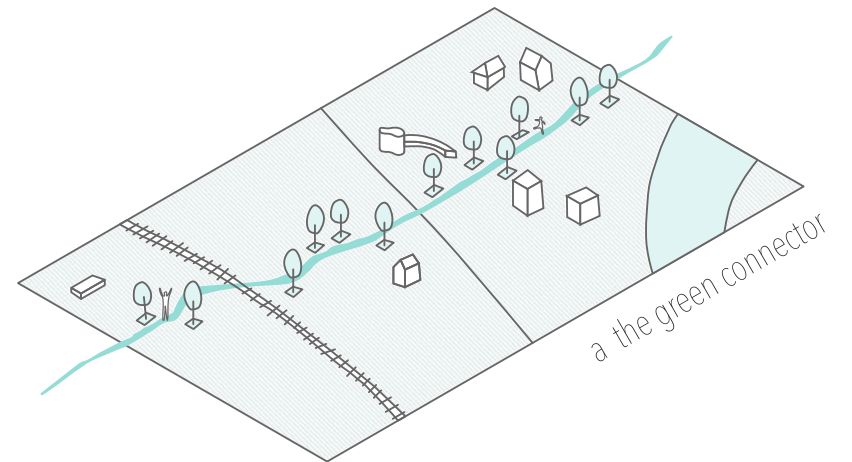
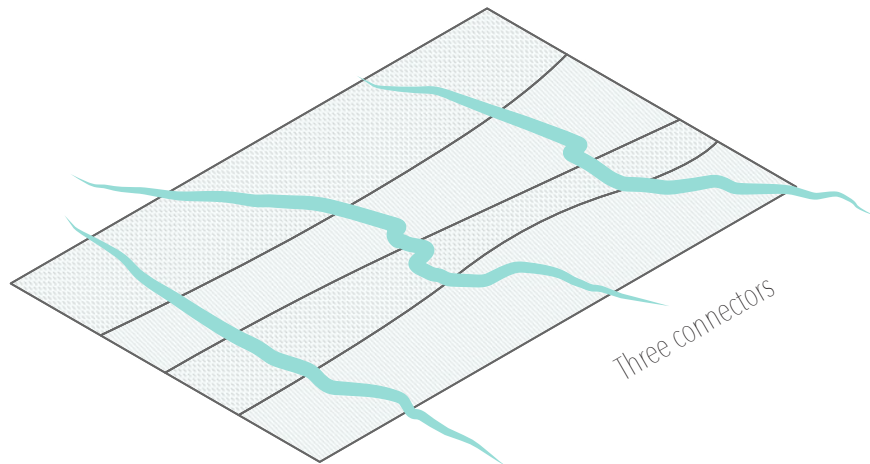

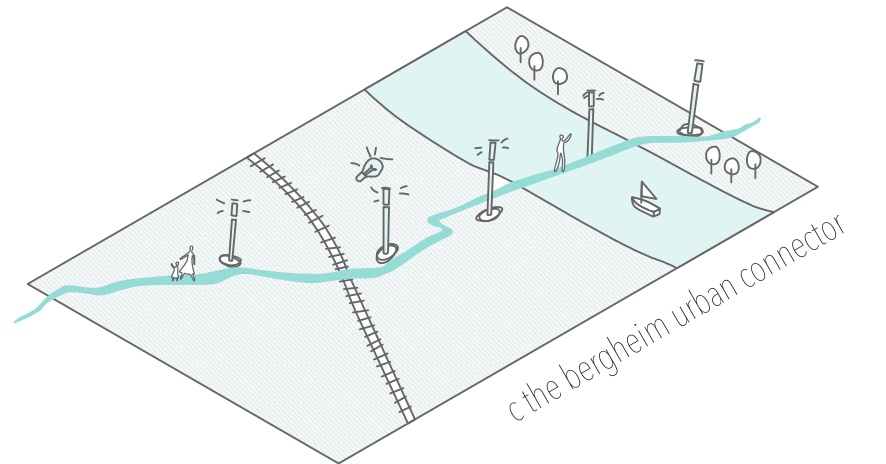
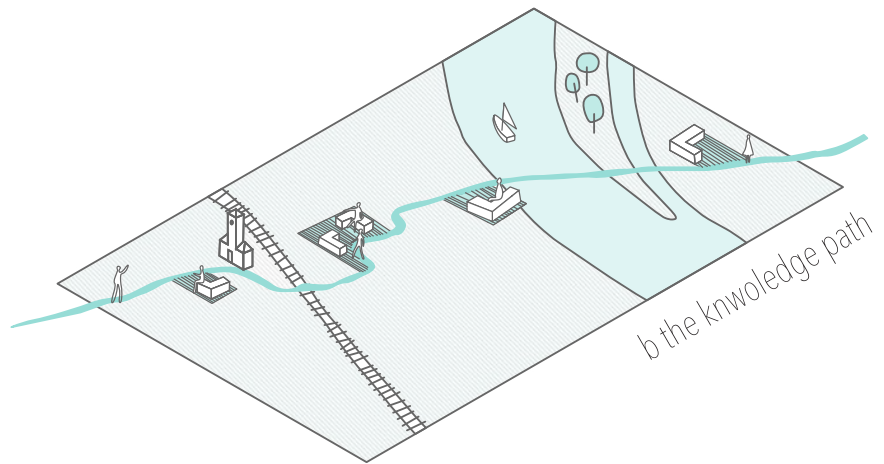
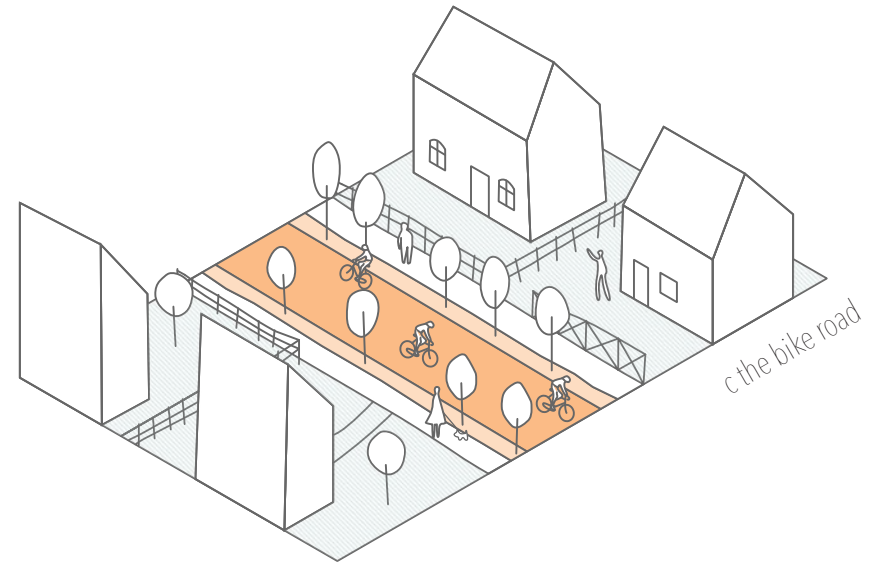
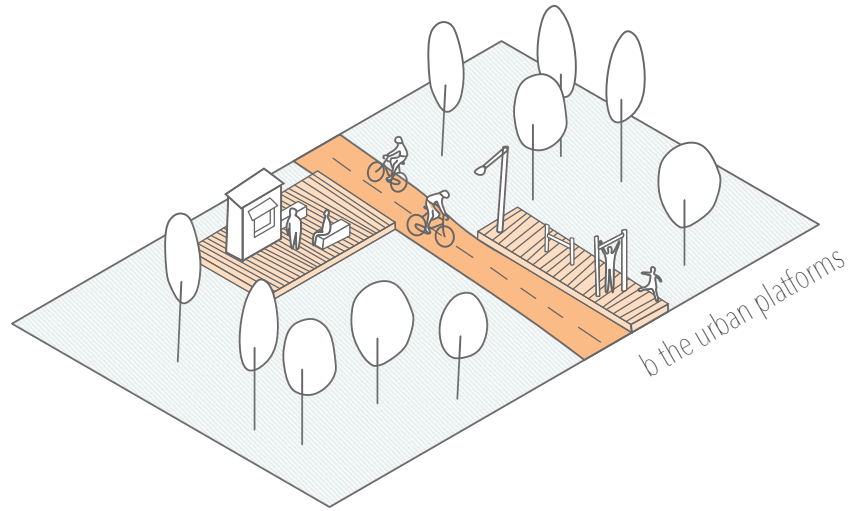

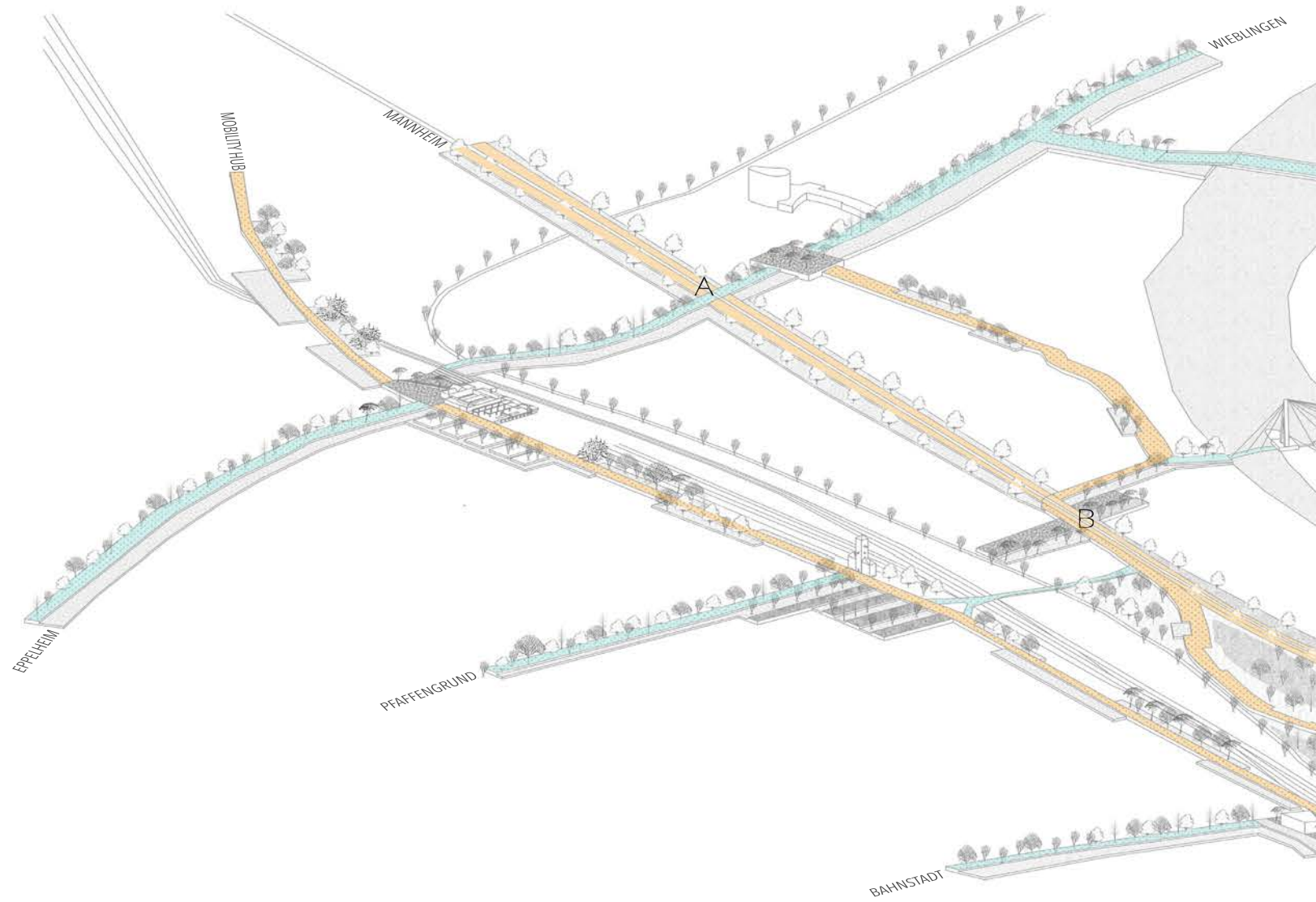



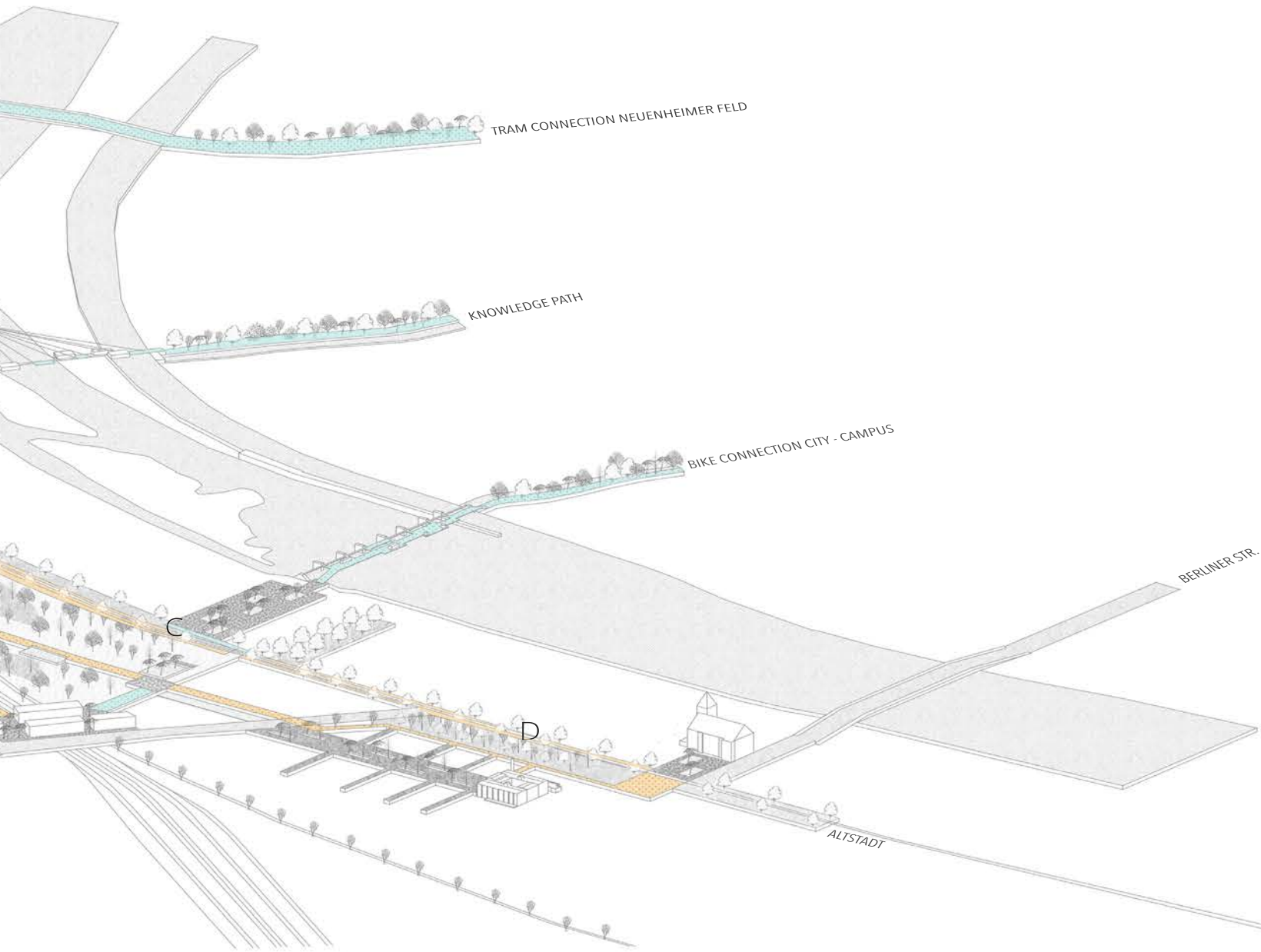





# ACT

SIX INTERVENTIONS CONNECTED TO THE NEW INFRASTRUCTURE

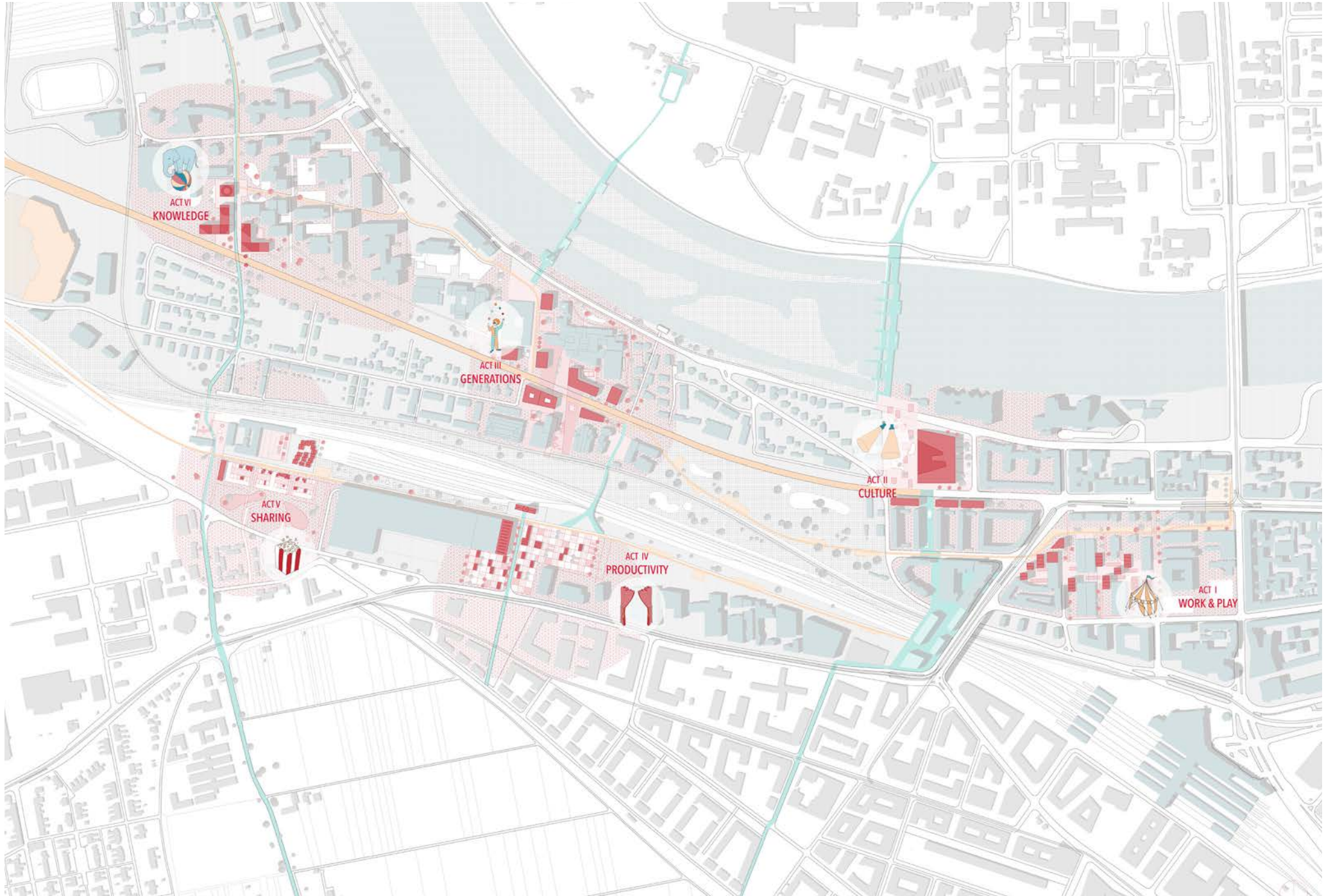

SIX ACTS



ACT I  
WORK & PLAY

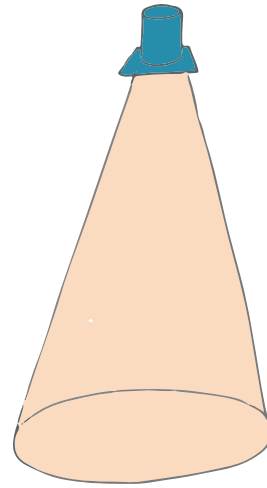

ACT II  
CULTURE



ACT III  
GENERATIONS

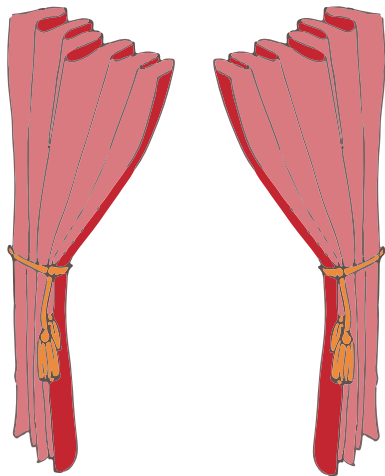

ACT IV  
PRODUCTION



ACT V  
SHARING

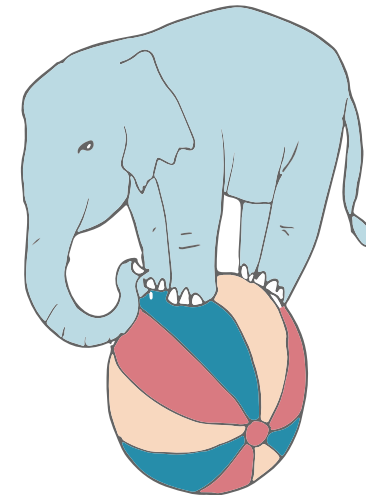

ACT VI  
KNOWLEDGE



# ACT I

## WORK & PLAY



## PREMISE

The Tramdepot will be relocated, leaving a large empty plot in the middle of Bergheim- West. We have designed a new use for the old building, adding structures and greenery that will evolve with time.



## PROMISE



KNOWLEDGE



FOOD



GREEN



NIGHTLIFE



COMMERCE



LEISURE



DEBATE

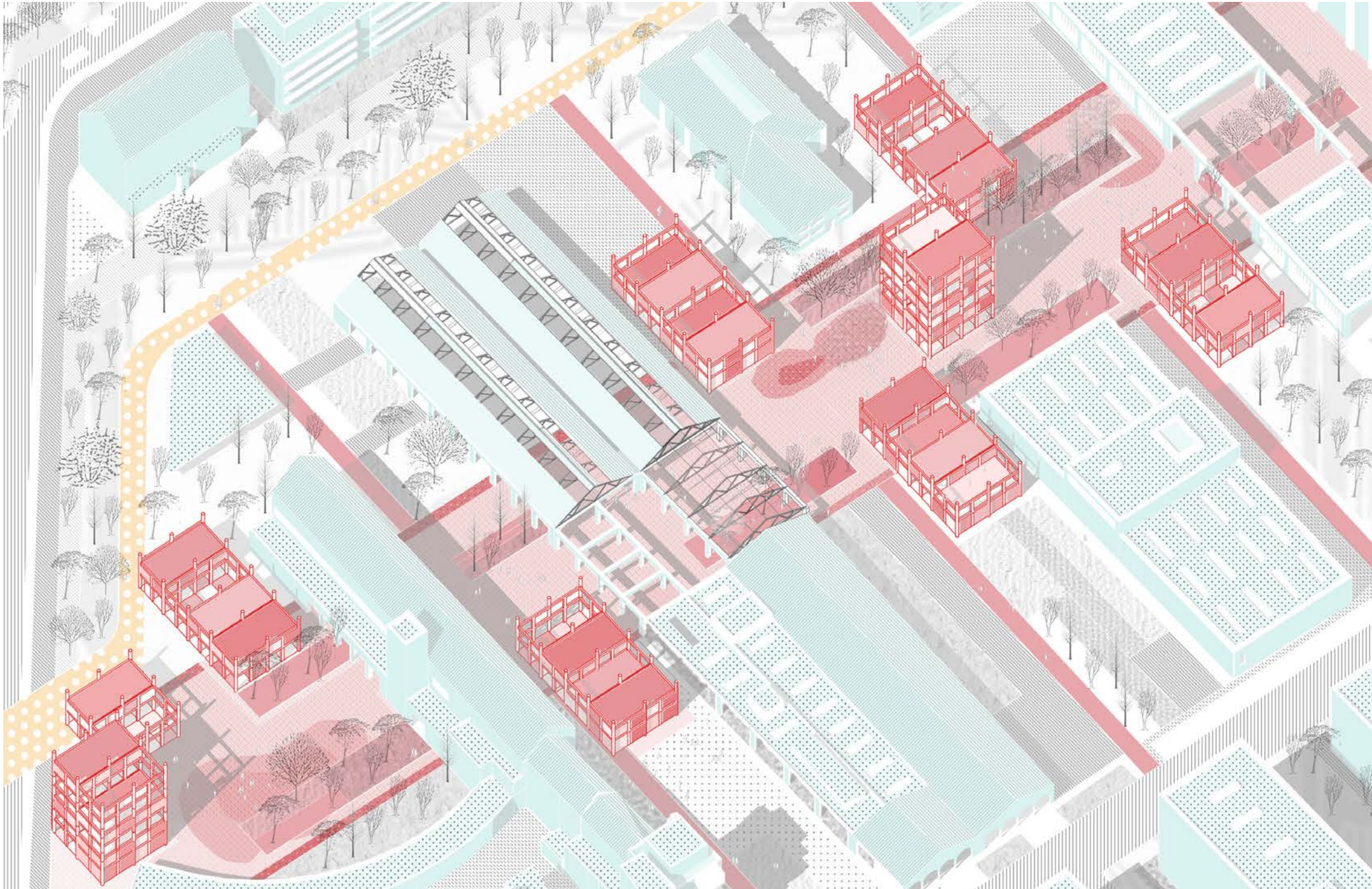





ACTIONS

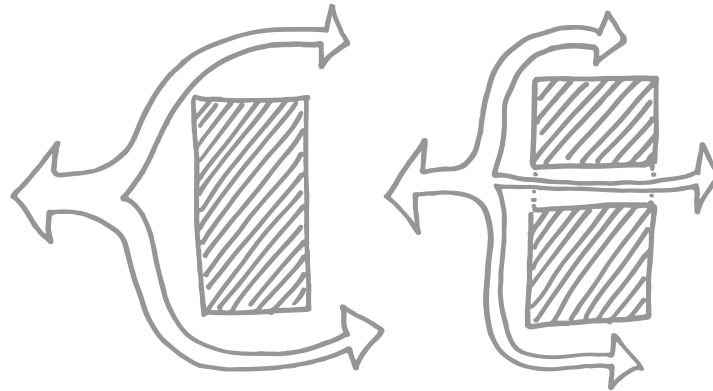

OPEN THROUGH

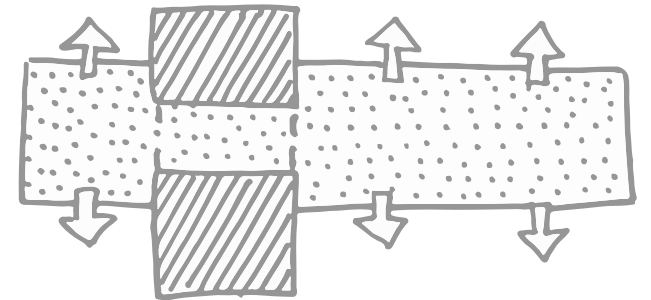

RELATION NORTH-SOUTH

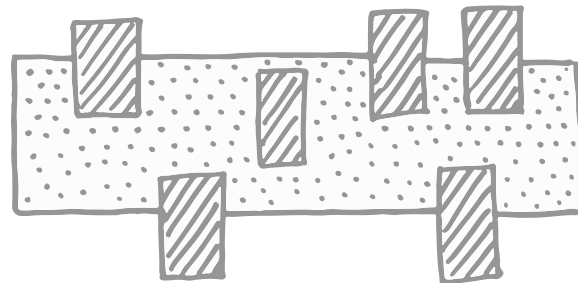

NEW ELEMENTS

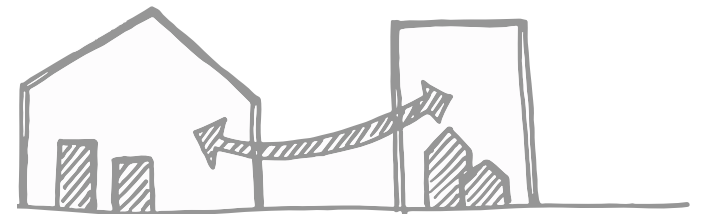

INTERACTION



## ACTOR

FRAU YAVUZ, 43, CLEANING PERSONEL

## BEFORE

I moved to Germany , from Turkey, five years ago. My husband works in a restaurant, and my kids go to school in Heidelberg. I make their food and clean our home, and I clean at the hospital at night. I still don't know how to speak german, and I really miss Turkey.



## AFTER

I quit my old job cleaning at the hospital, and now I spend my days at the culture and language integration centre at the old tram depot. I am starting to feel more at peace here in Heidelberg, especially after I got the opportunity to open my own food stall in the food court of the old Tramdepot, where I can cook real Turkish food for the people that come here and talk to them about their day to day lives.



# ACT II CULTURE

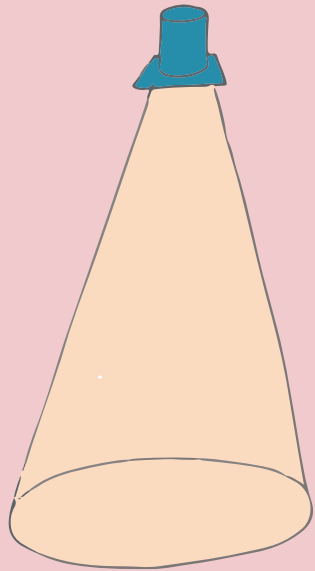

## PREMISE

The existing disfunctional traficated green space is transformed to a large culture house that will help connect neighborhoods. It will allow for a central district in Bergheim- west, working in symbiosis with the new tramdepot site.



## PROMISE



STAGE ART



SIGHT



GREEN



NIGHTLIFE



MUSIC



LEISURE



MUSIC

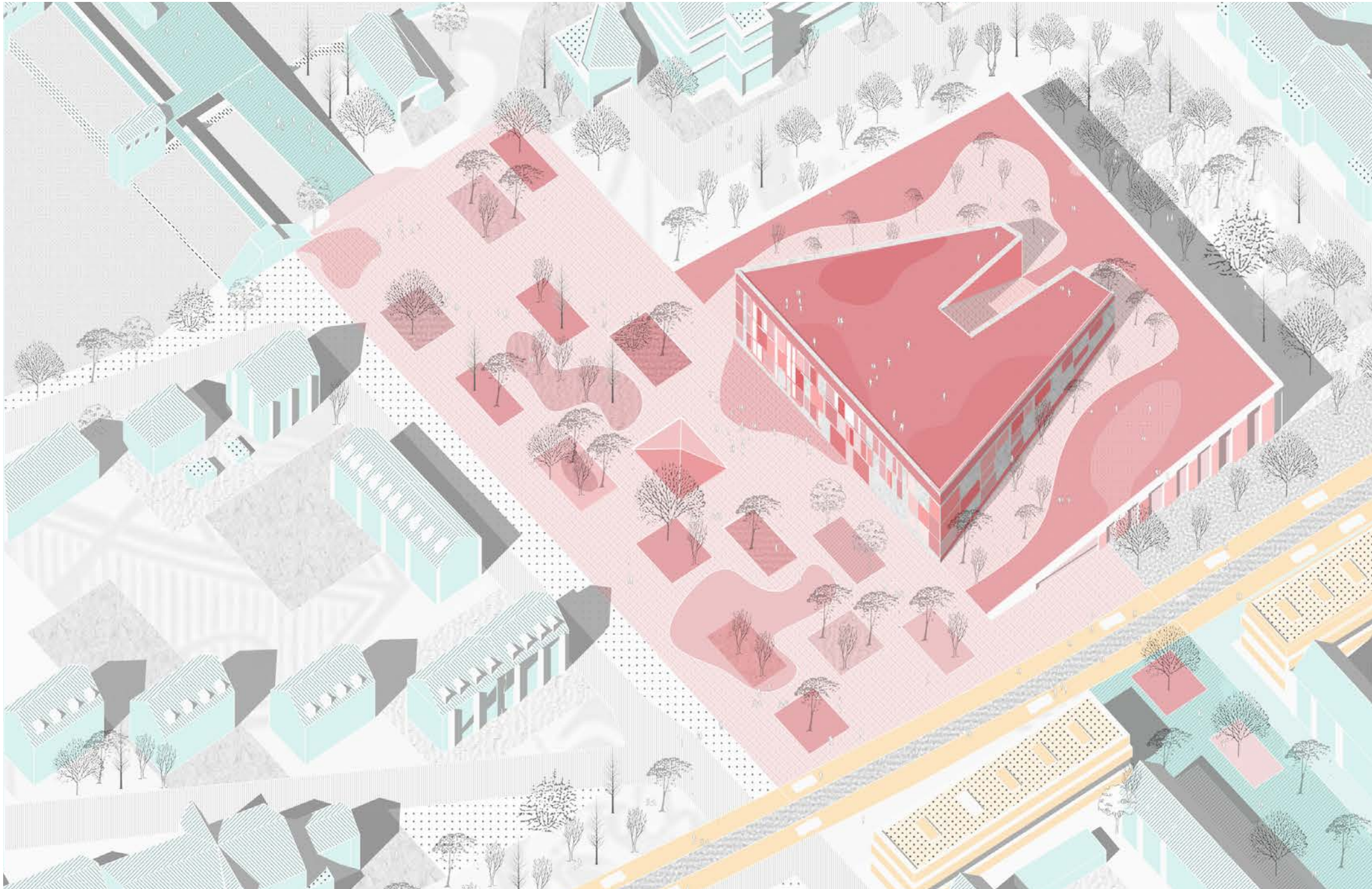



ACTIONS

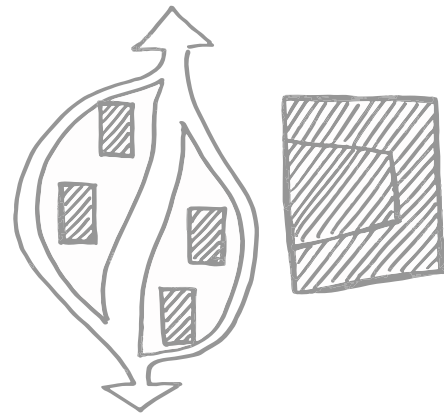

MOVING THROUGH



ROOF WITH A VIEW



RECOGNIZING FACES



24 HOUR LIGHTING





## ACTOR

DR. STEINER, 57, ONCOLOGIST

## BEFORE

I come to Heidelberg and the hospital once a year for the cancer research conference, and I love it, but I'd really like to see more of the city! It just feels like too much of a hassle with the distances at this time.



## AFTER

Since the rework done in Bergheim, I love coming to Heidelberg more than ever. After a long day at the cancer conference, I always walk back across the Wehrsteg bridge, buy myself some new and exciting food at the old tram depot, and bring it back to the roof of the culture house to enjoy my food with a nice view of the river, before heading inside for a concert or movie or whatever else I can find of entertainment and culture. I'm even considering bringing my family here for vacation next summer!



# ACT III GENERATIONS



## PREMISE

There are many schools, however none of them work together. We have solved this by adding new structures that will embody different generations so that the school zones becomes a hub for not only children but adults of all ages.



## PROMISE



INNOVATION



HOUSING



GREEN



COMMERCE



KNOWLEDGE



LEISURE



DEBATE

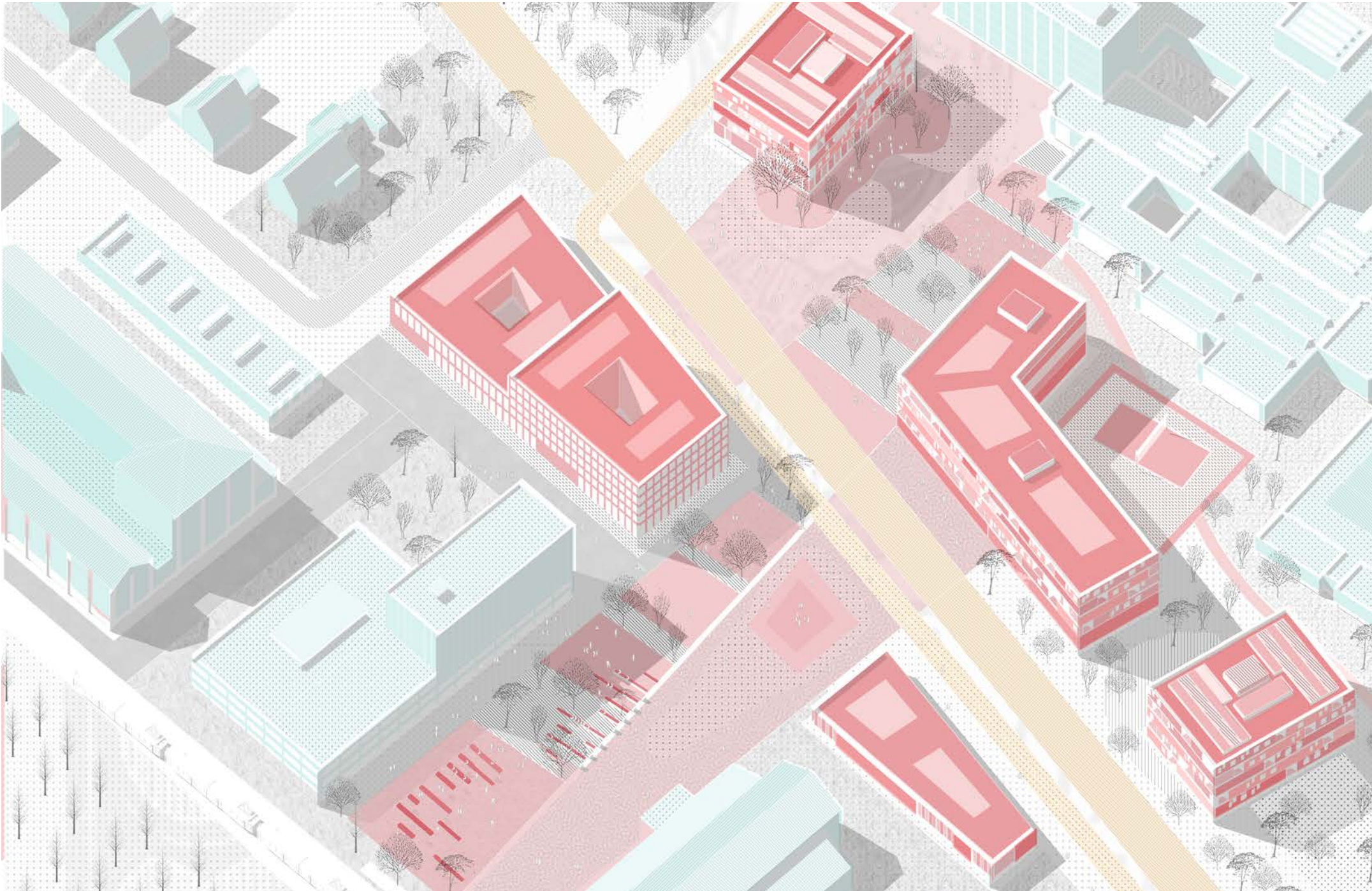

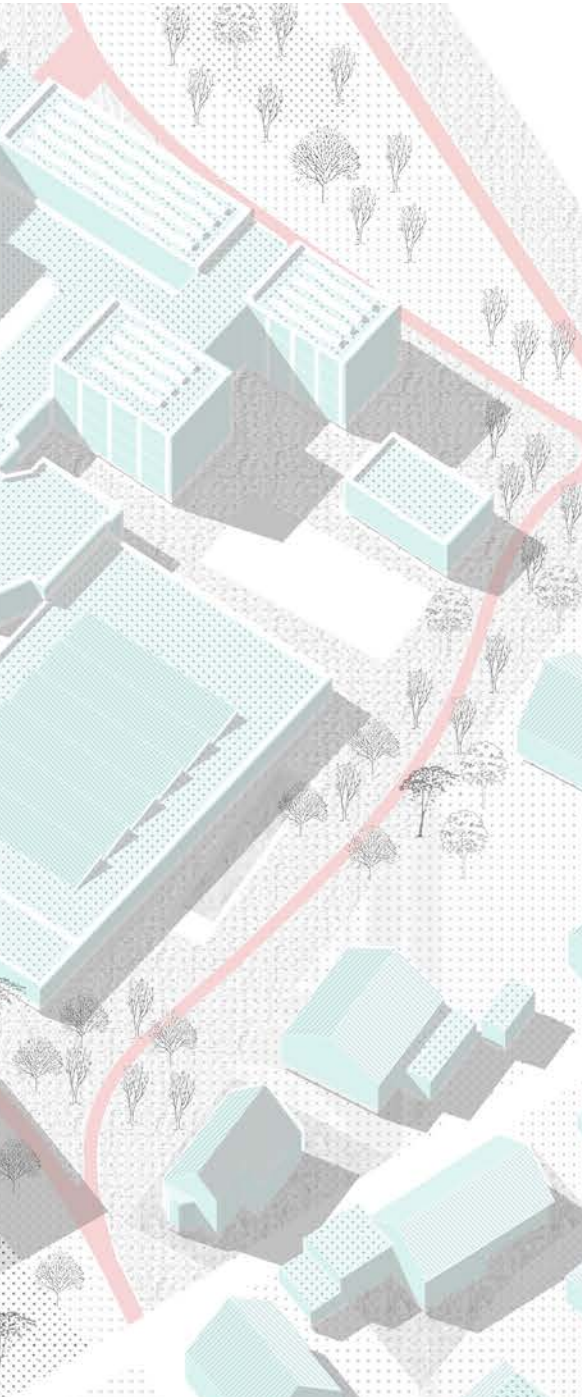

ACTIONS

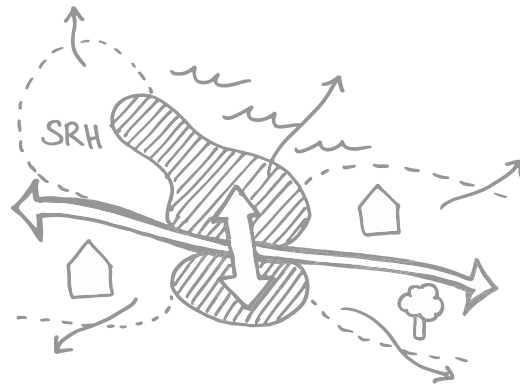

SCHOOL DISTRICT CONNECTIONS

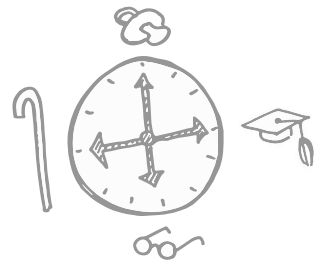

24 HOUR USE FOR ALL GENERATIONS

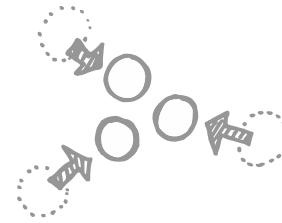

CENTRALIZATION

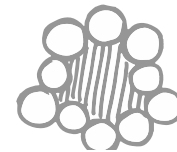

NEIGHBOURHOODS

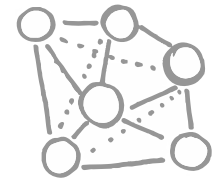

LOCAL NETWORKS

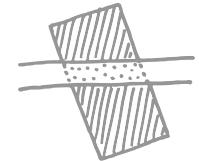

CONNECTING SQUARE

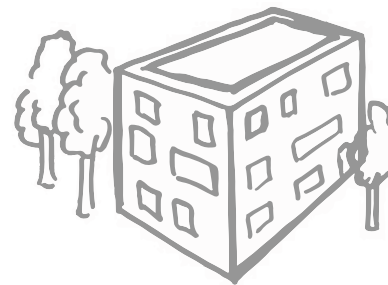

URBAN VILLA FOR GENERATIONS

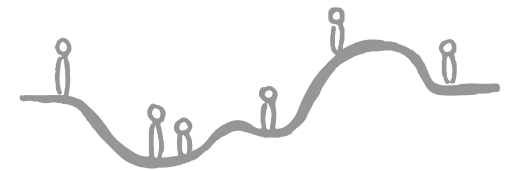

TOPOGRAPHY LINKING SQUARES



ACTOR  
HERR SCHNEIDER, 89, RETIRED

BEFORE

After the loss of my wife, I have become rather lonely in my big apartment. I would like a smaller and cheaper one, but I find moving too scary. What if no one misses me when I'm gone?

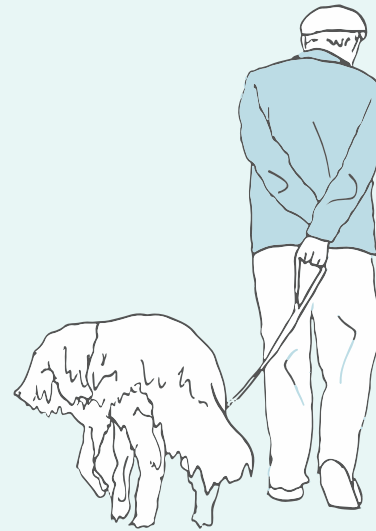

AFTER

I moved to my new apartment at the campus, and i just love having all the vibrant life around me. I go for walks in the park every day. The Neckar is within 10 minutes of me, and I enjoy resting on the viewing platform. In the afternoon, I give piano lessons at the open school's music clubs. It's fantastic to see these young talents grow up, and to be a part of it. Now I can just hope to have more people from other neighbourhoods join in!





# ACT IV PRODUCTION

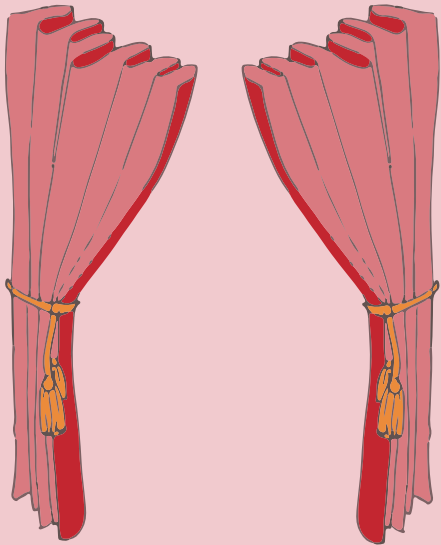

## PREMISE

The Tankturm stands alone in a prestigious manner compared to the new development in the south. We have introduced a new way of building sustainable structures by using materials that are locally grown on site. It will develop to be a place where people can learn different trades and get involved in sustainability.



## PROMISE



HOUSING



FOOD



GREEN



LIVESTOCK



CRAFTS



FRUITS



BEEES

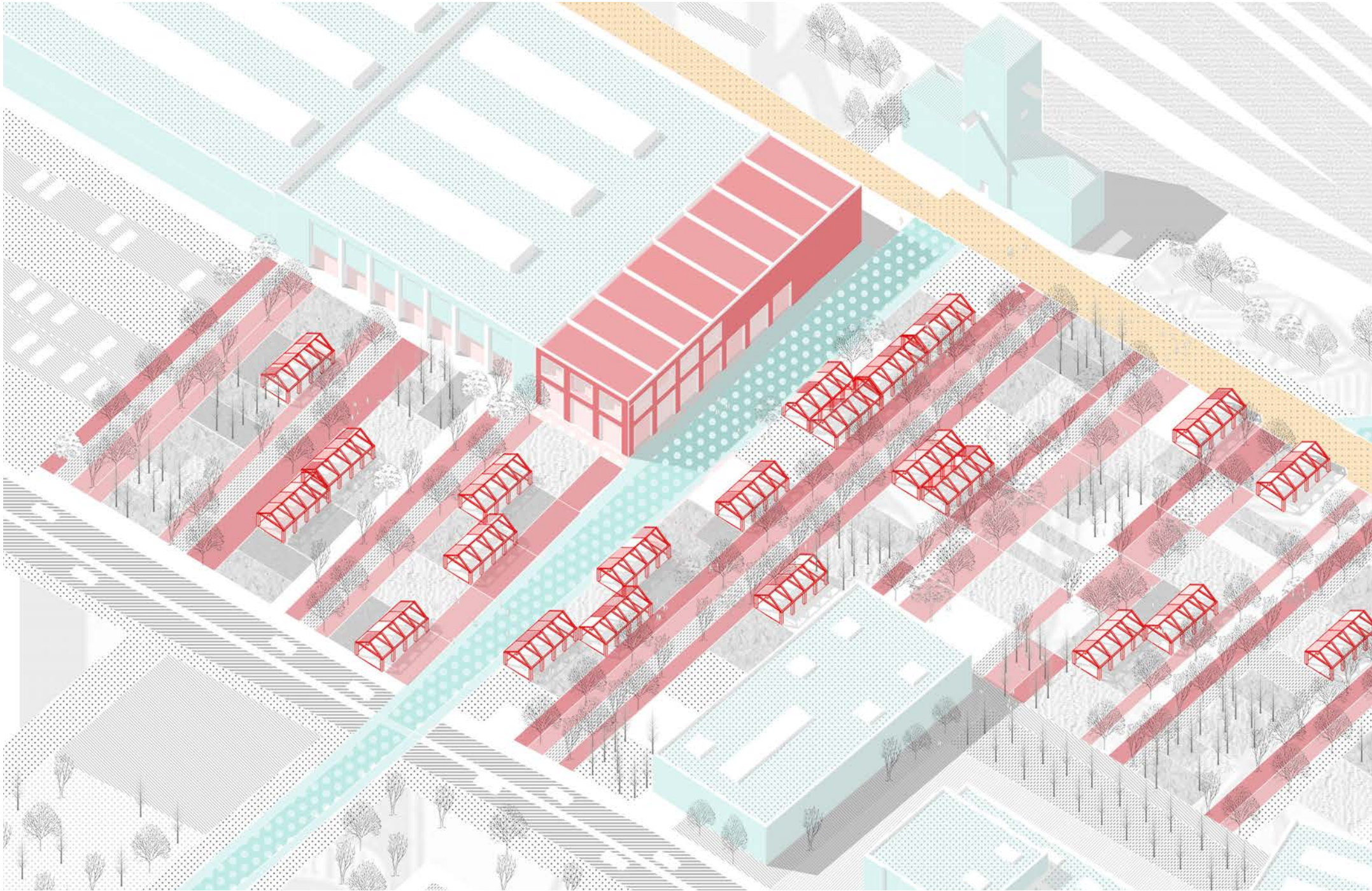

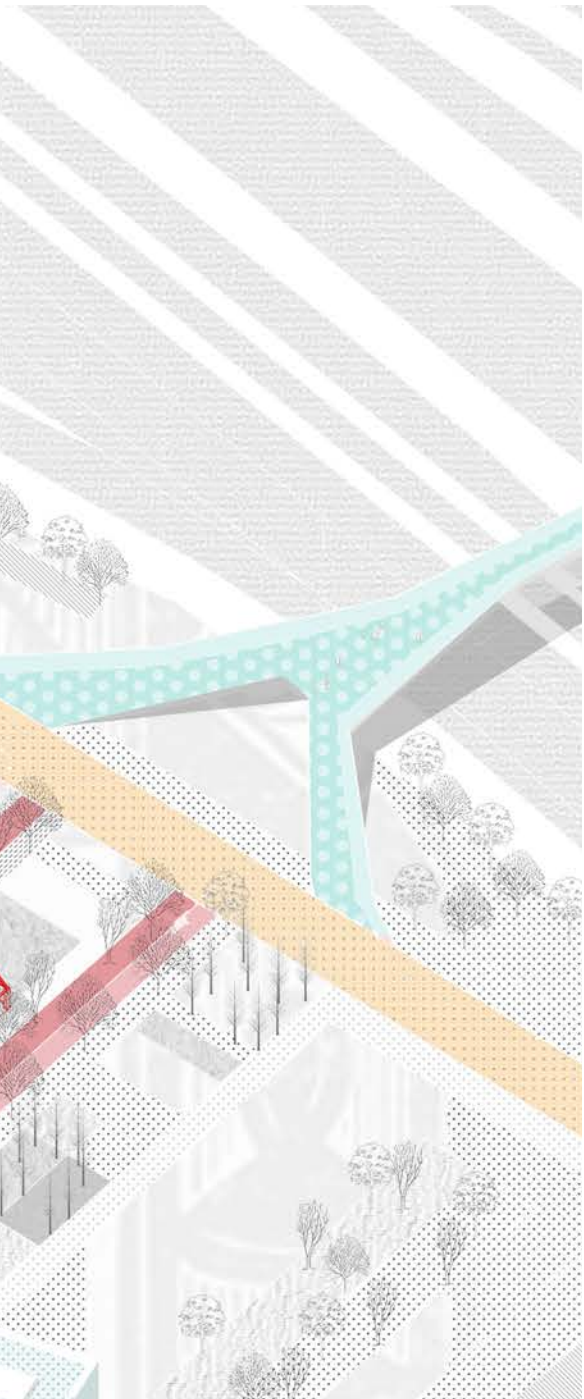

ACTIONS

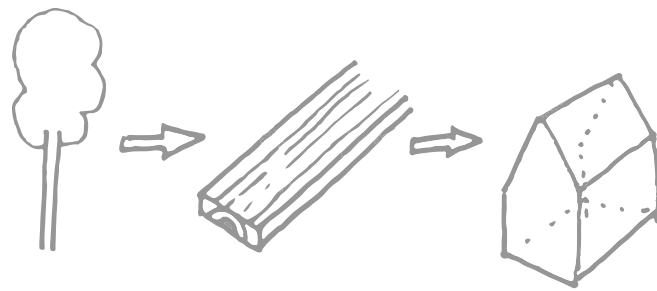

LOCAL PRODUCTION

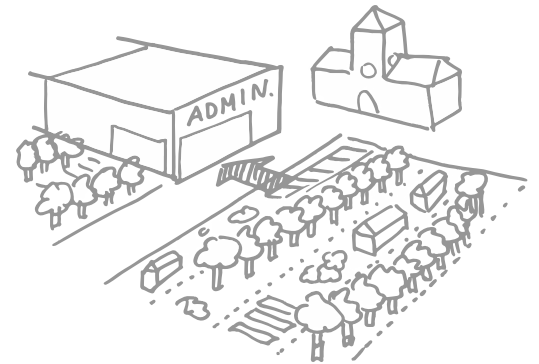

INTERACTION BAUHAUS

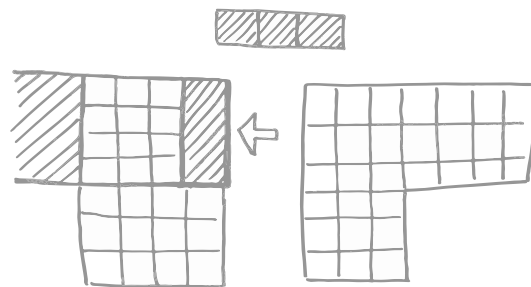

PARCEL LAYOUT

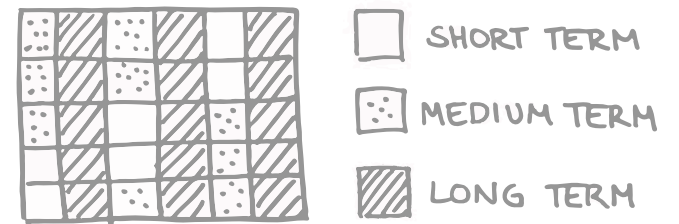

RENTAL TERMS



## ACTOR

PAUL, 39, CARPENTER

## BEFORE

I lost my job two years ago, and since, I've spent my days as a stay at home dad. It's nice, but I'd really like to get back to being useful for other people than just my family!



## AFTER

After years of doing little handy work, I'm finally back at it, and it's better than ever. I was hired as the advisory carpenter to the tank turn collective, where I help locals set up their sheds and structures. In between, have evening classes in construction to help the Betriebswerk village builders and other locals with an interest for carpentering. It's nice to feel useful again!



# ACTV SHARING



## PREMISE

South west on our site is a mixture between established housing and agricultural fields. We have developed sharable apartments that meet the need of the neo-modern family.



## PROMISE



INNOVATION



HOUSING



GREEN



KNOWLEDGE



LEISURE



CRAFTS



DEBATE

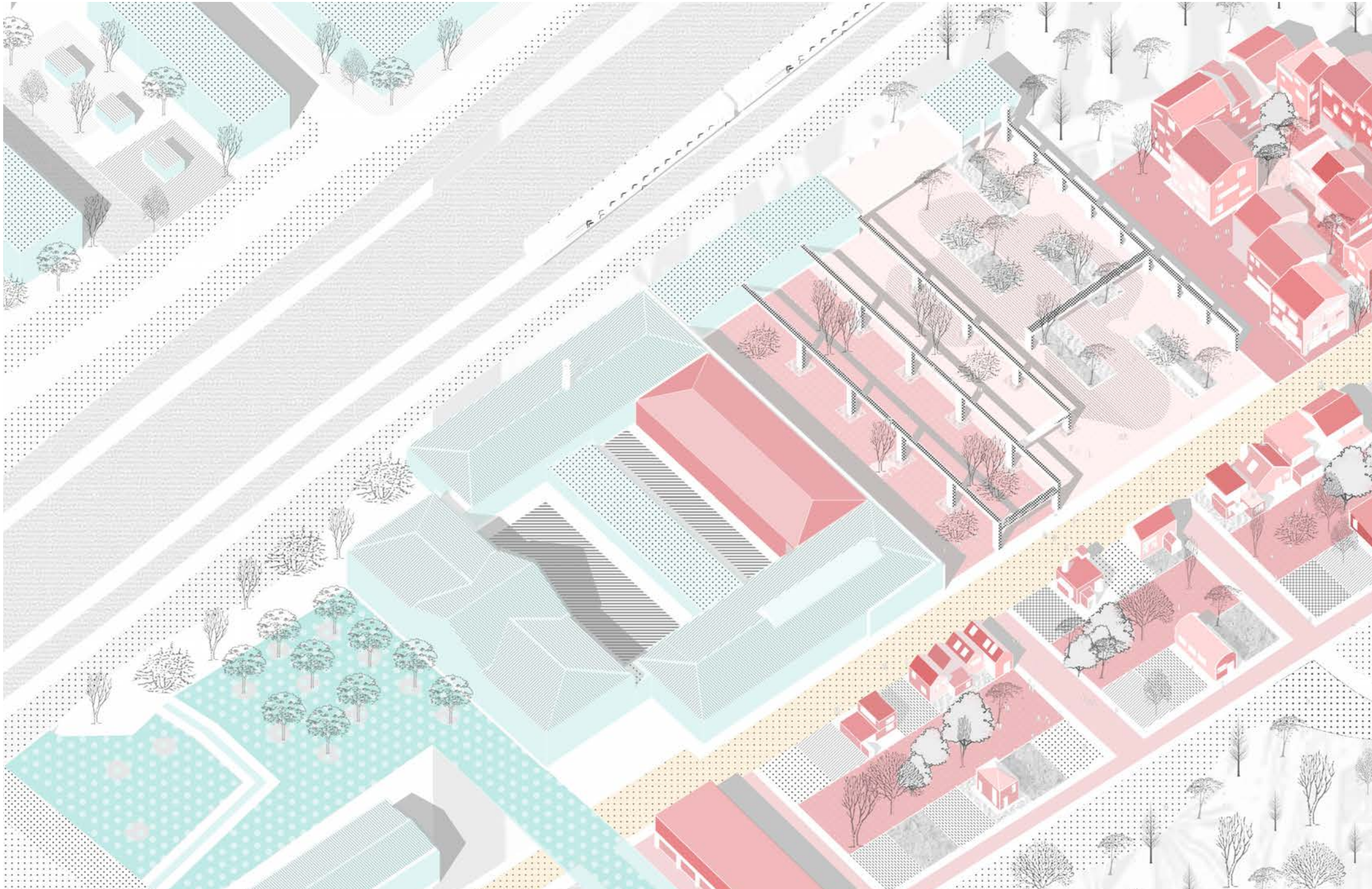





ACTIONS

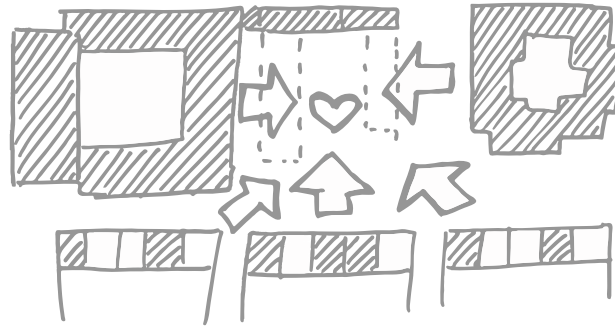

CONCRETE RUIN AS NEIGHBOURHOOD PLAZA



PARTICIPATORY PLANNING

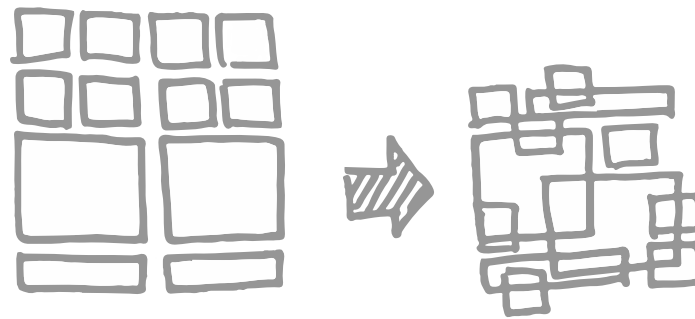

OVERLAPPING FUNCTIONS FOR SMALLER FOOTPRINT

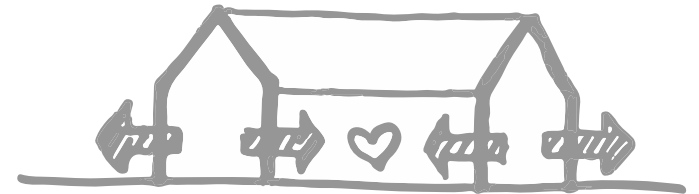

INTROVERTED AND OUTVERTED SHARING

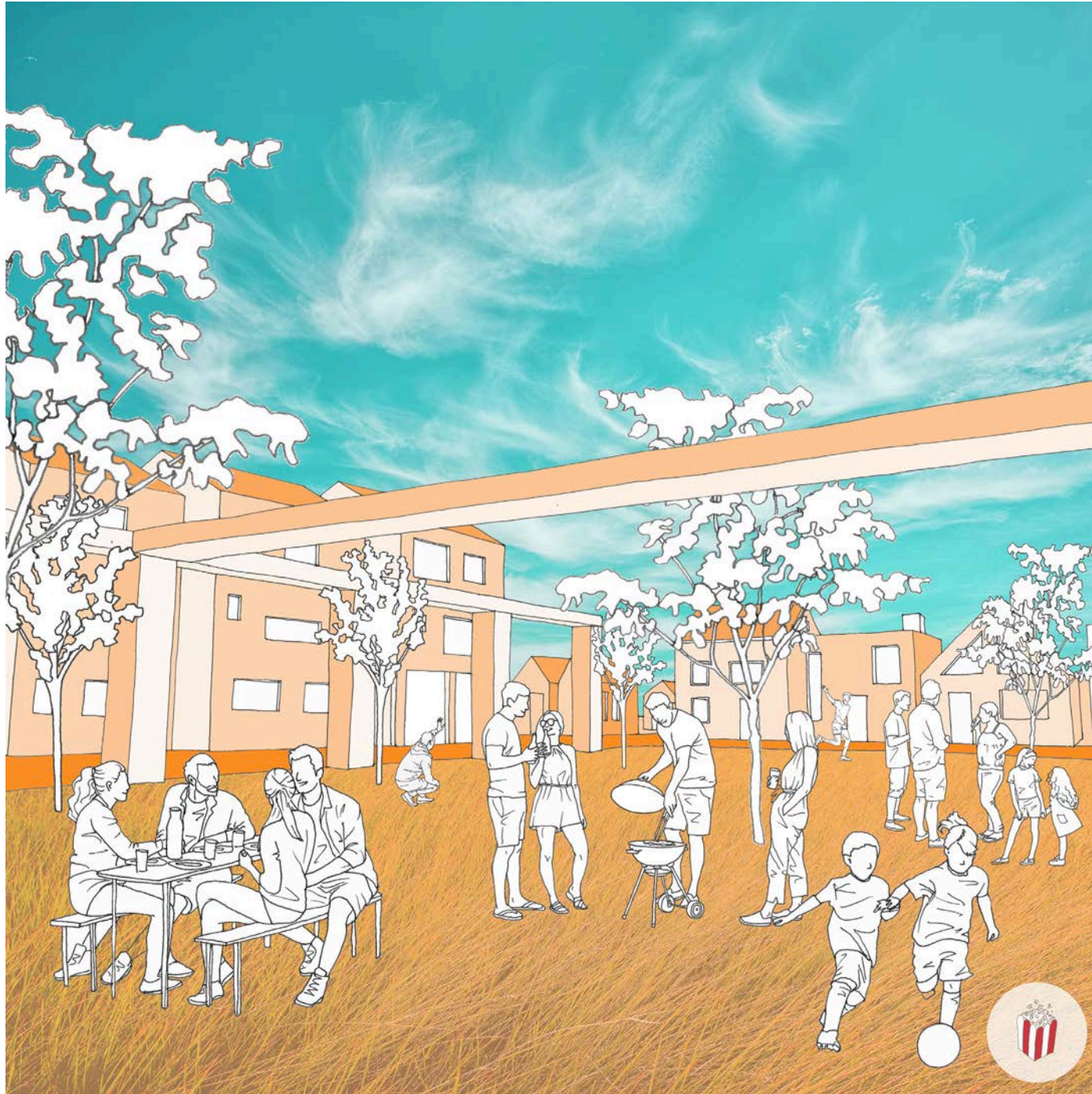

## ACTOR

RACHEL, 37, BANK MANAGER

## BEFORE

I just moved to Bahnstadt after my divorce, and I have a brand new, huge apartment, but no one to invite over. I don't even know my neighbour's name!



## AFTER

Once I heard of the Betriebswerk collective project, I knew I had to join in. Living with so many others can sound terrifying, but we were all a part of the planning process, and i now share a home and life with such an amazing group of people. Sure, it can be tiring, but i always have the choice to retreat to my own little apartment to relax. I usually just end up going outside to the concrete jungle instead, though.



# ACT VI KNOWLEDGE

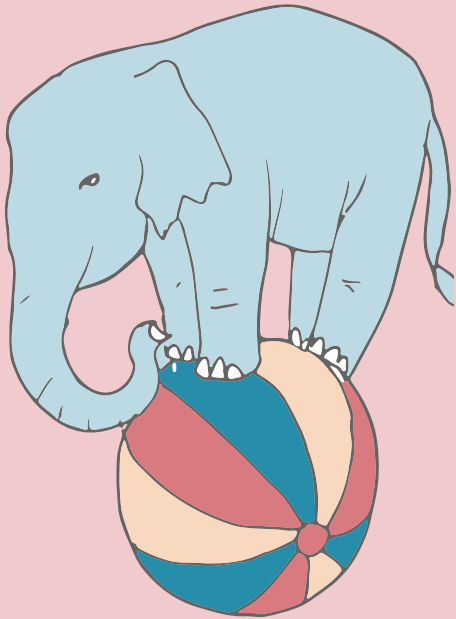

## PREMISE

The SRH- campus needs a better connection with the outside world. By mixing functionality and ownership, we have tried to make a space where housing, commerce and education meets. This is a situation where knowledge can grow.



## PROMISE



INNOVATION



COMMERCE



GREEN



NIGHTLIFE



KNOWLEDGE



LEISURE



DEBATE

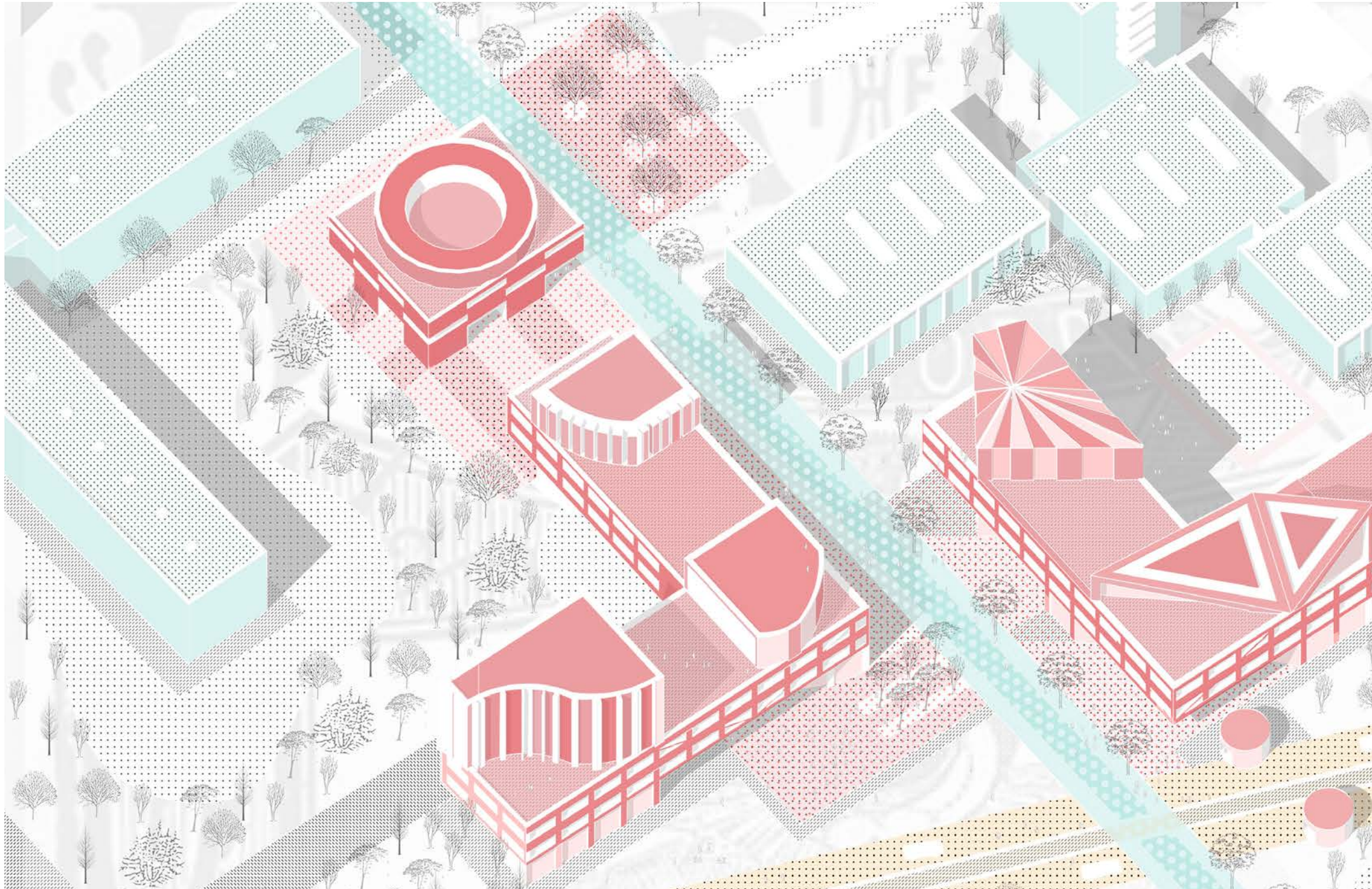



ACTIONS

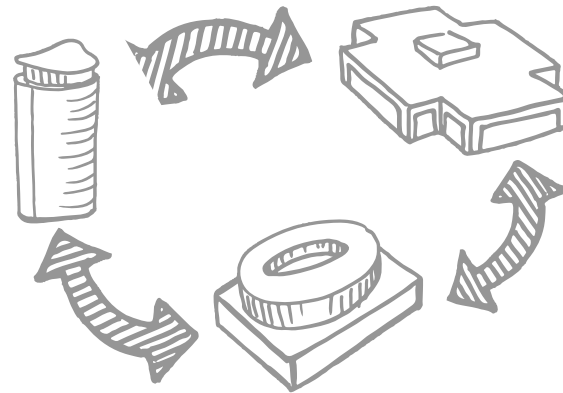

UNIVERSITY INTEREST POINTS

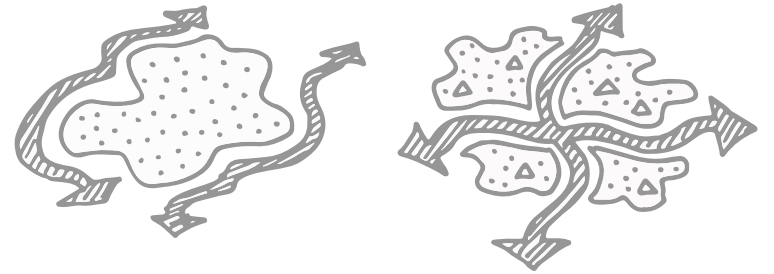

CITY INTEGRATED CAMPUS

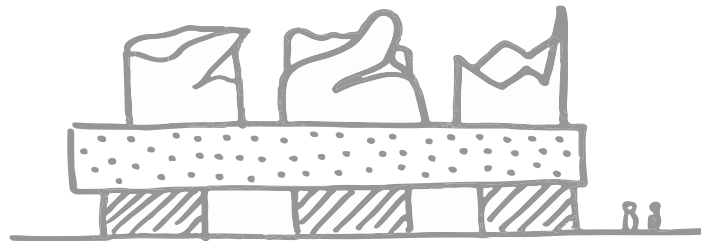

TPOLOGY FOR ENTRANCE BUILDINGS

BUSINESS  
SRH  
PEOPLE



MATERIALS

COLOUR  
GLASS  
WOOD  
CONCRETE





## ACTOR

STEFAN, 24, STUDENT

## BEFORE

I'm studying applied computer science at the SRH campus. After school, I run my start up from my dorm room, so I rarely get to enjoy the city. I guess I feel kind of isolated in my own surroundings.



## AFTER

After the new buildings at the south east of the SRH opened, I was so lucky to be given space for my startup in one of the towers. I get to hang out with other entrepreneurs and exchange tips and tricks, and we even have bigger businesses stop by to talk to us about our work. The vibe is really inspiring, and after we are done for the day, it's relaxing to grab a beer together at the new student society next door. After all, I'm still a student!





# GROW

ANALYSIS OF THE MADE PROPOSALS AND POSSIBLE EVOLUTION IN TIME

# THE CIRCUS ON TOUR

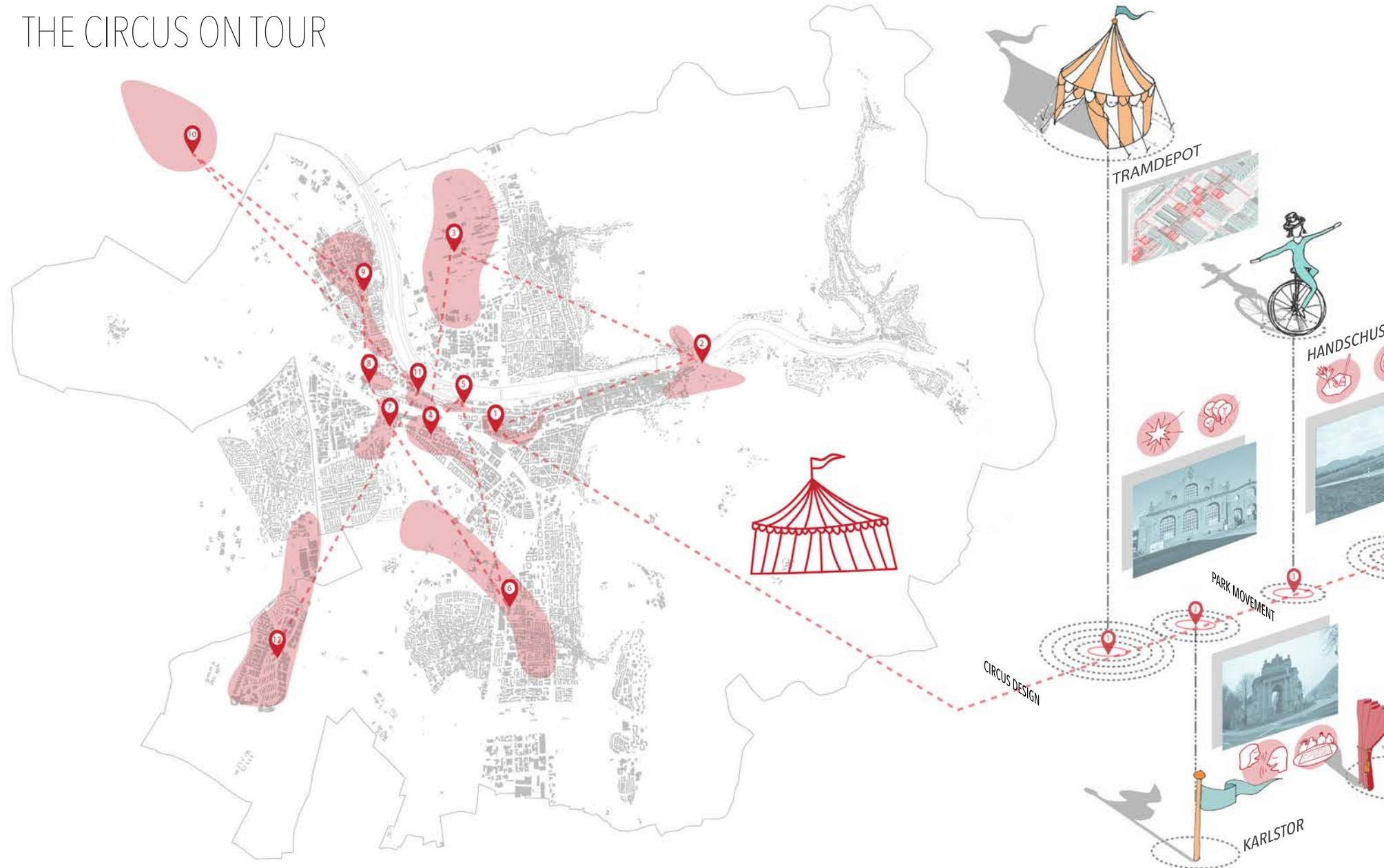

# TRAVELLING CIRCUS

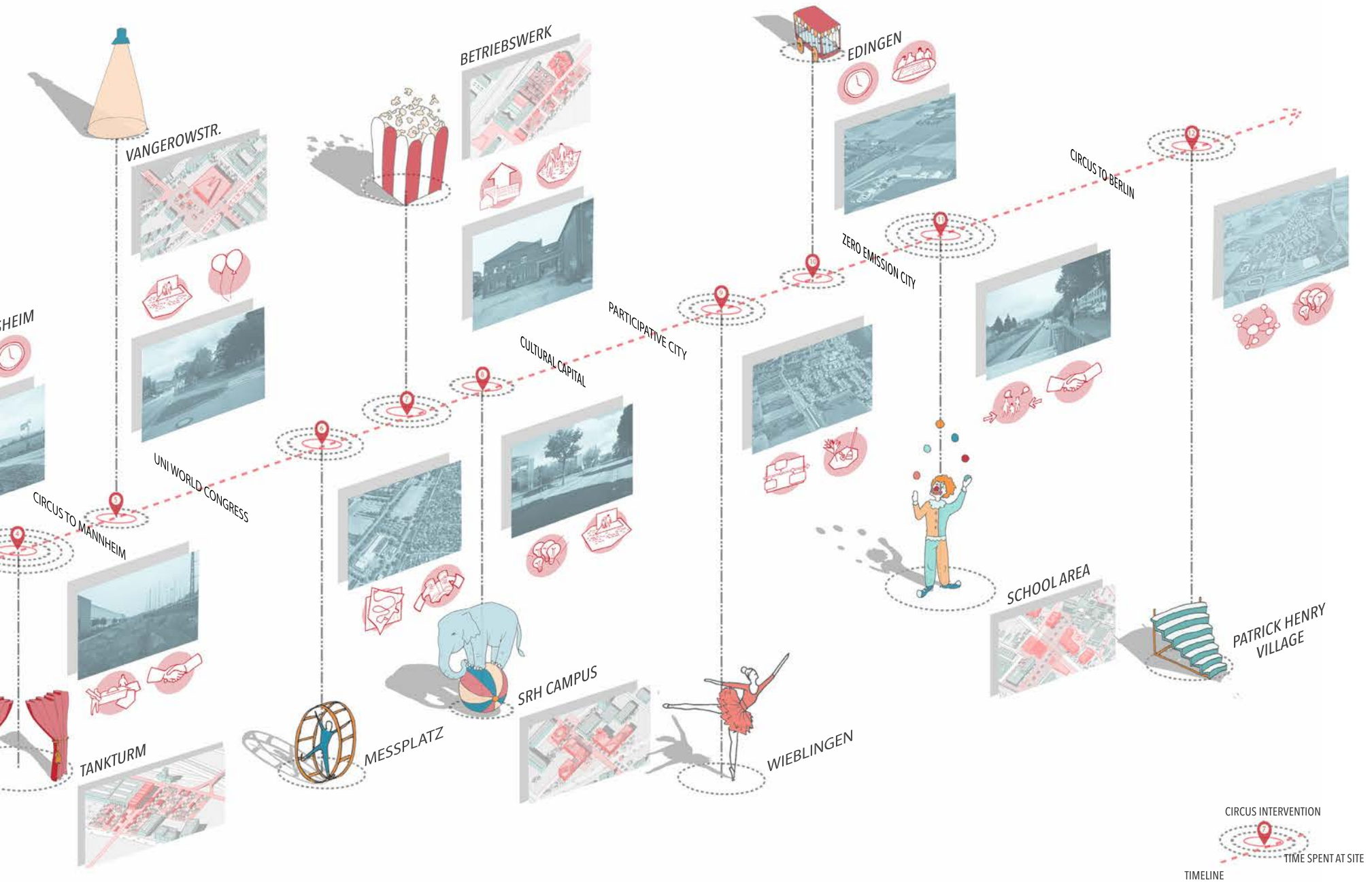

BERGHEIM-WEST

GROWTH-EVOLUTION

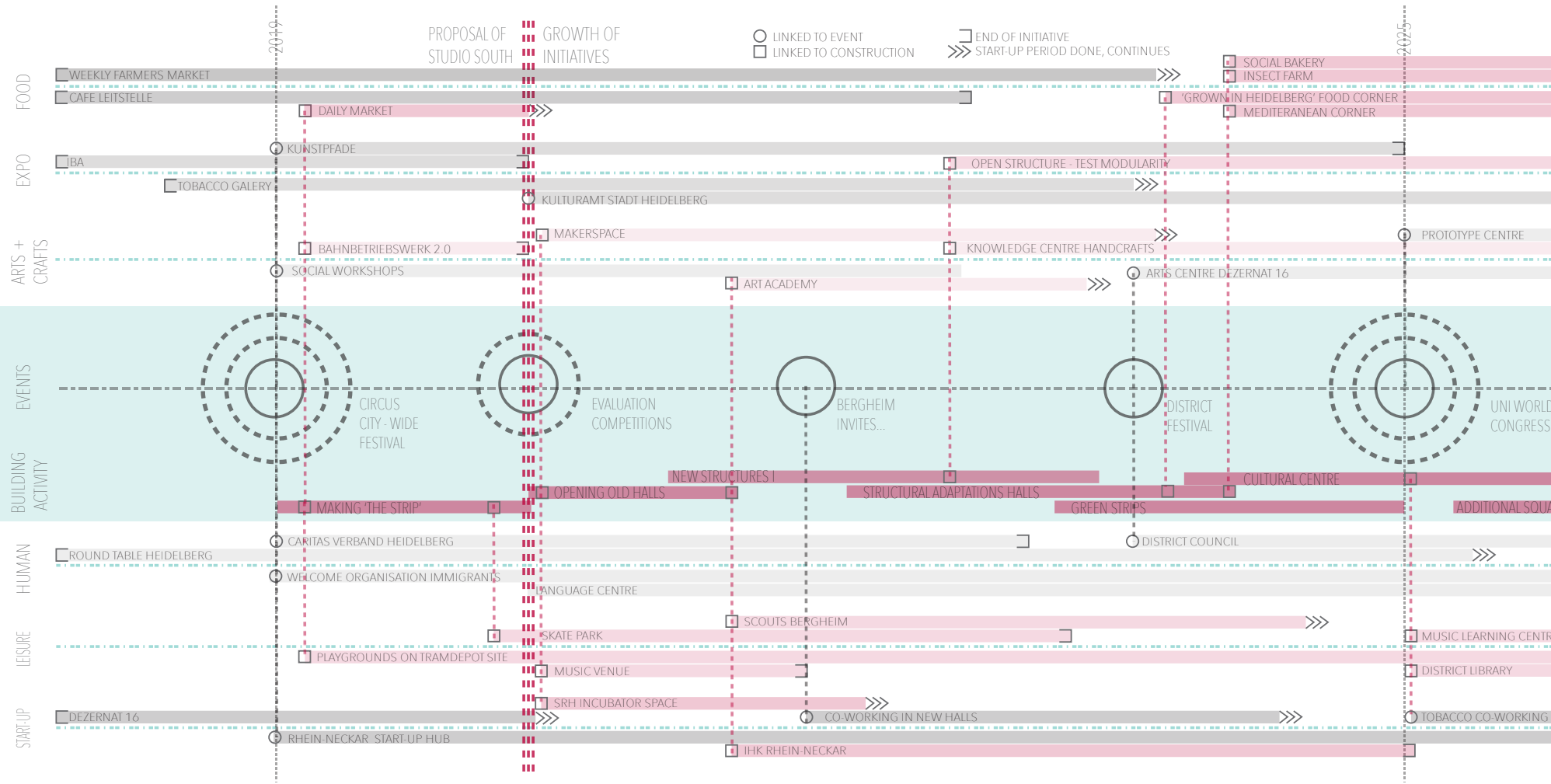

# POSSIBLE EVOLUTION

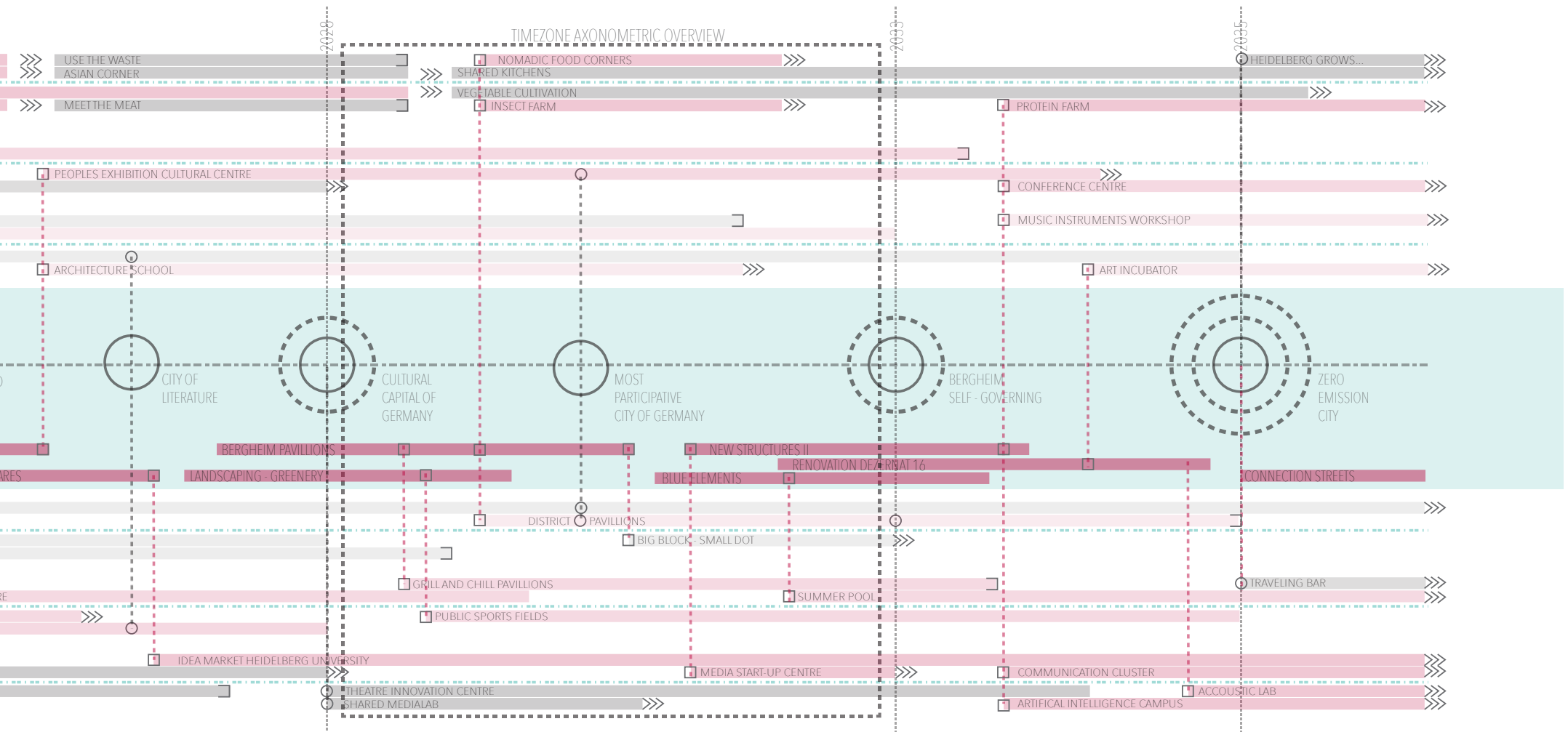

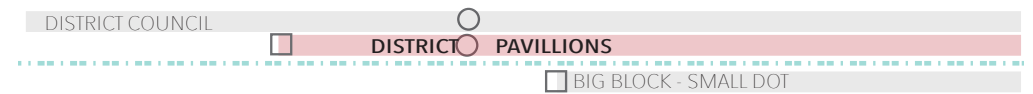
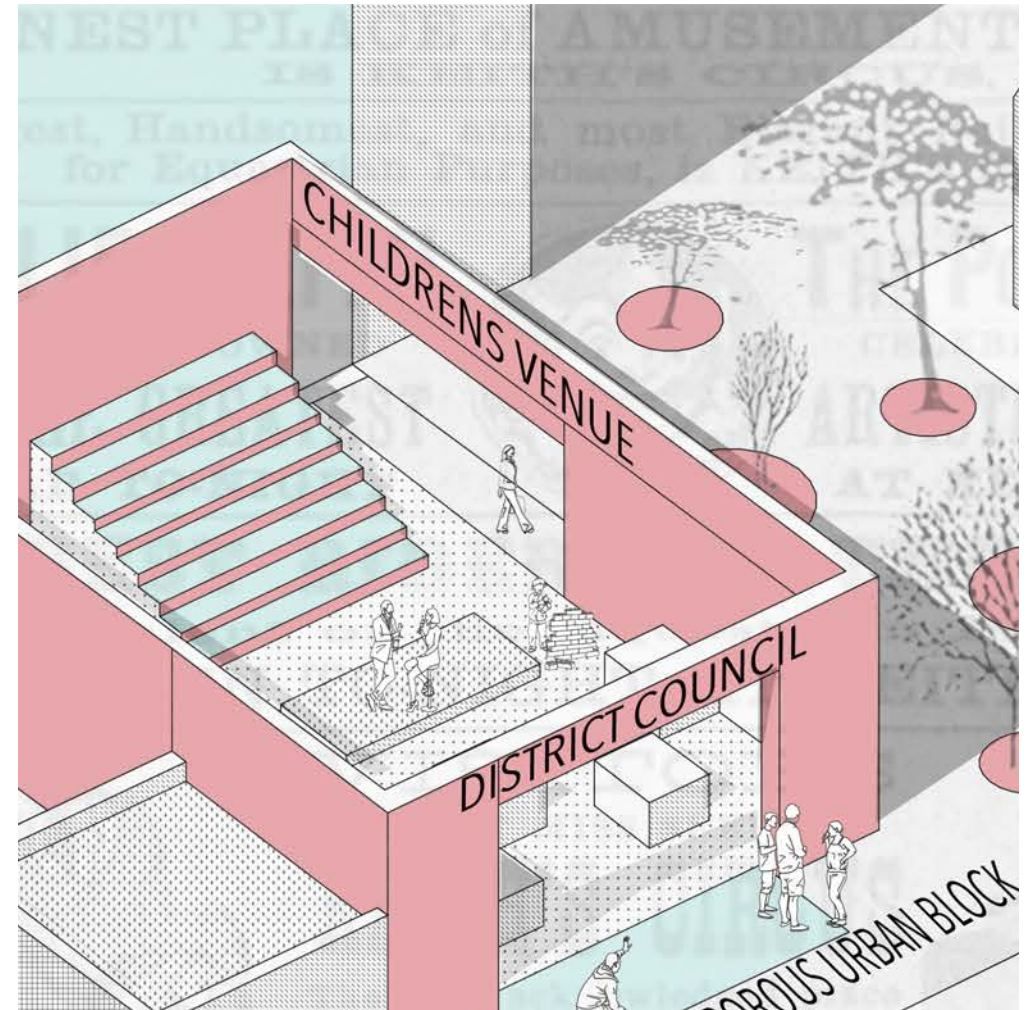
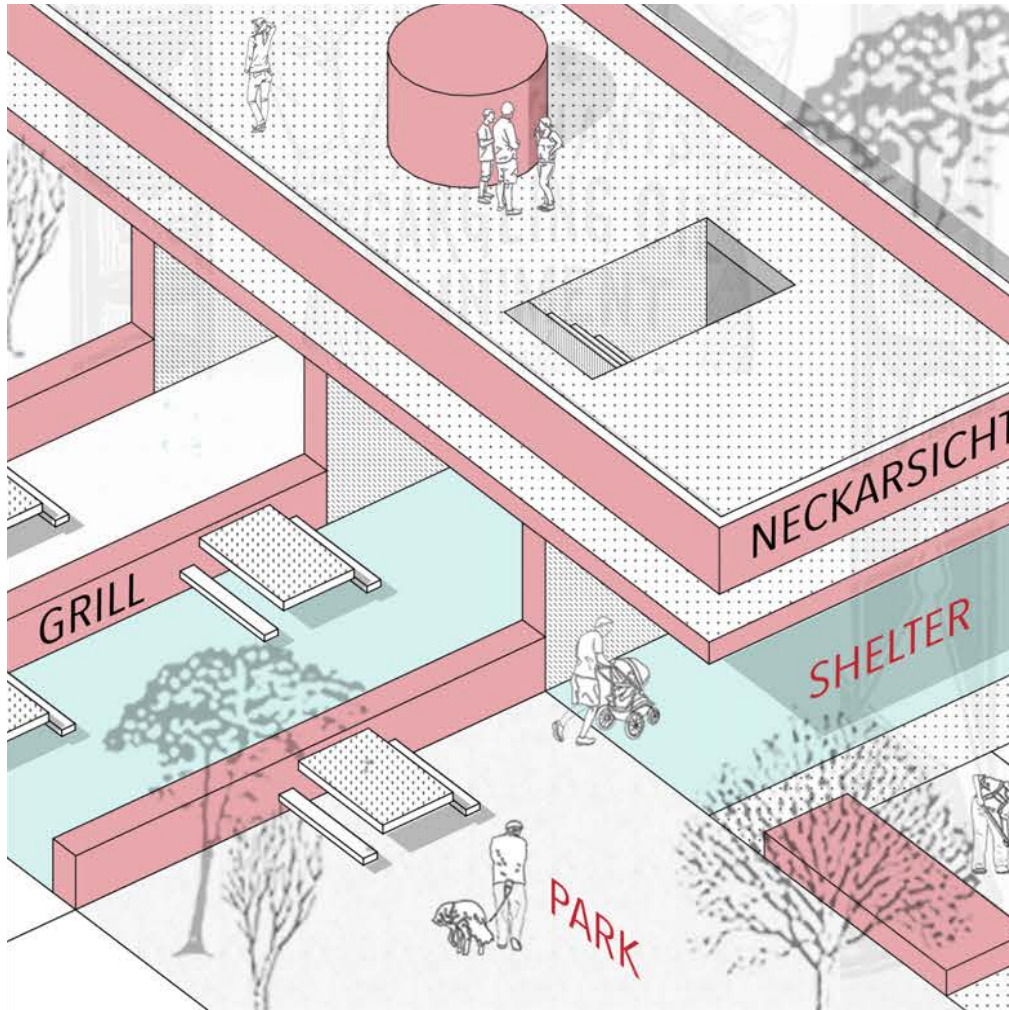



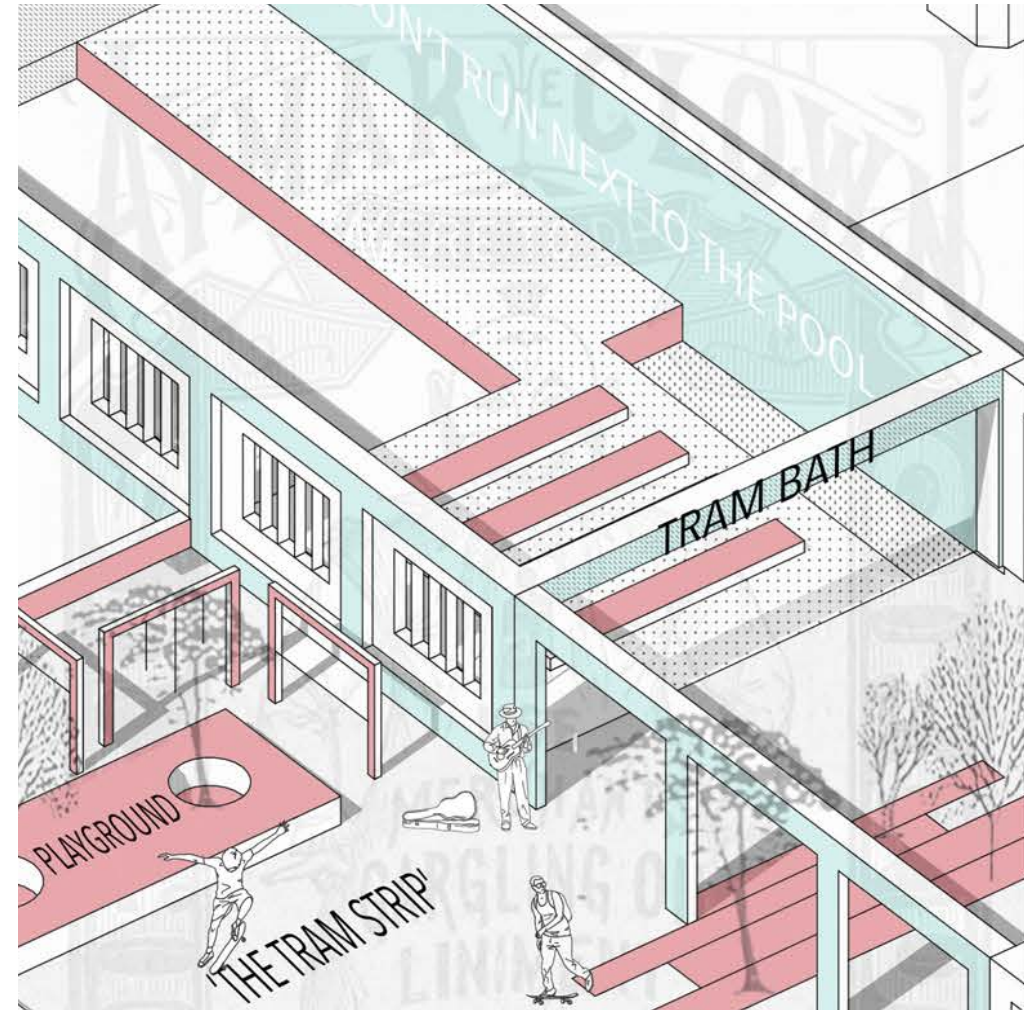
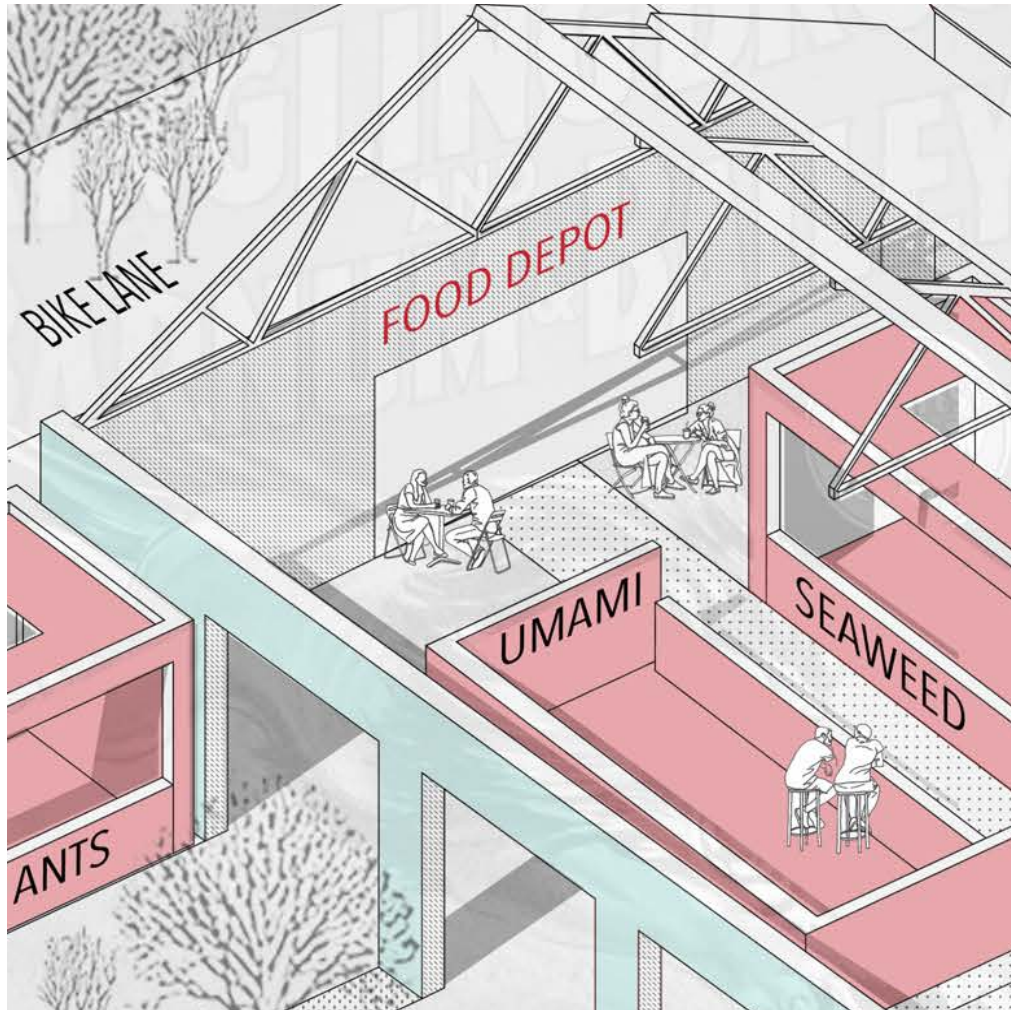

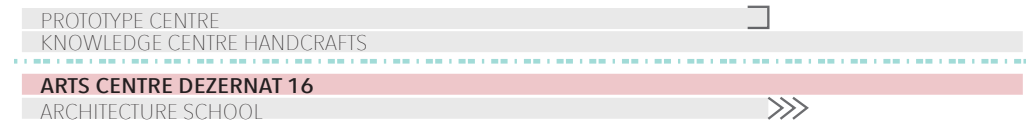
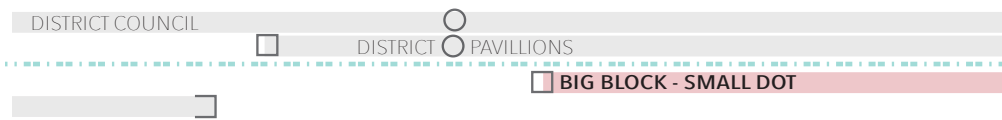
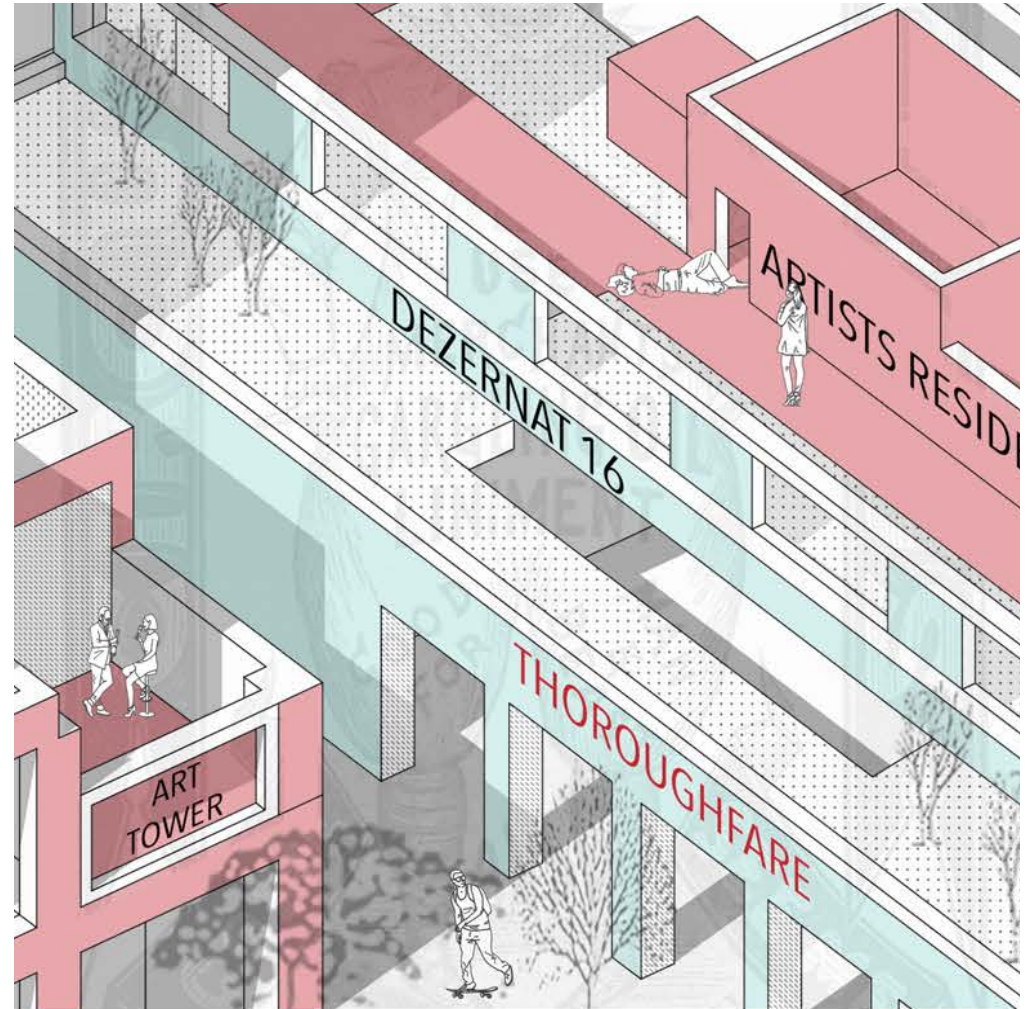
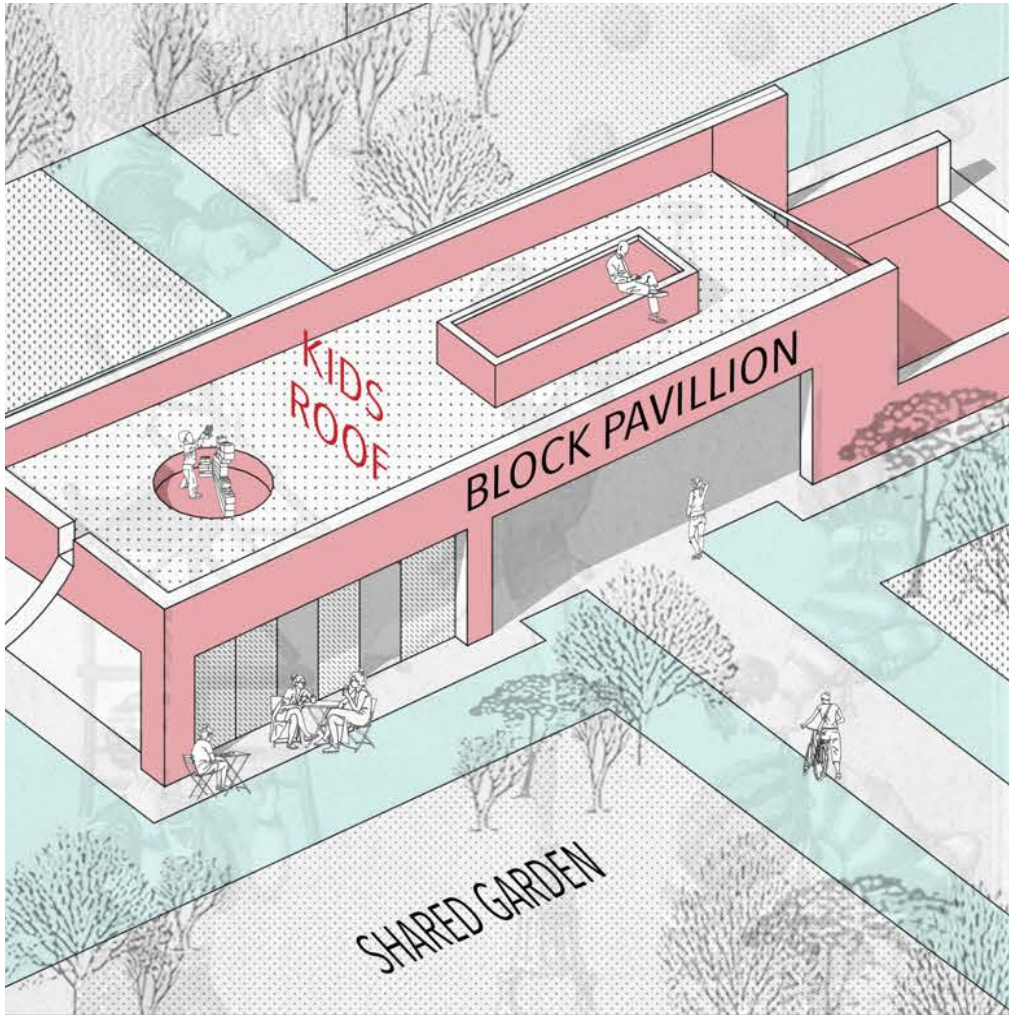

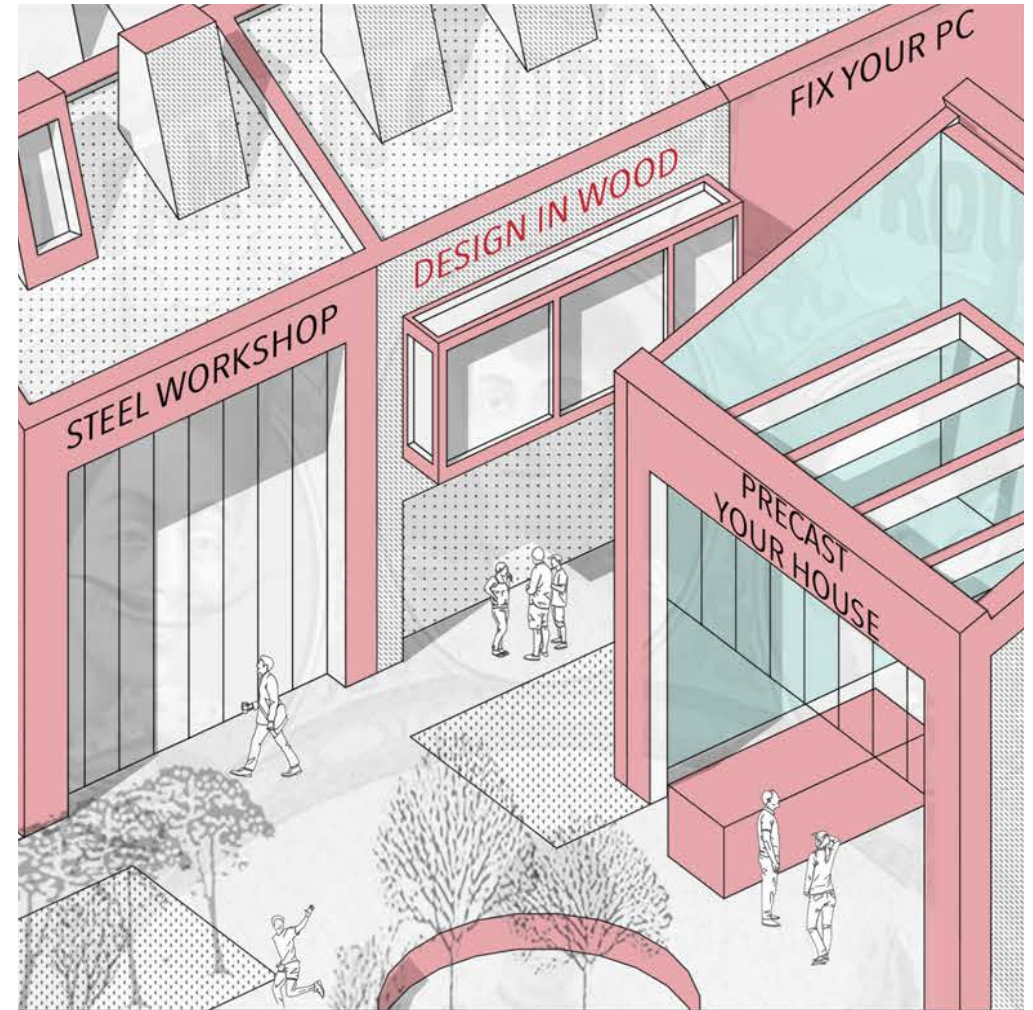
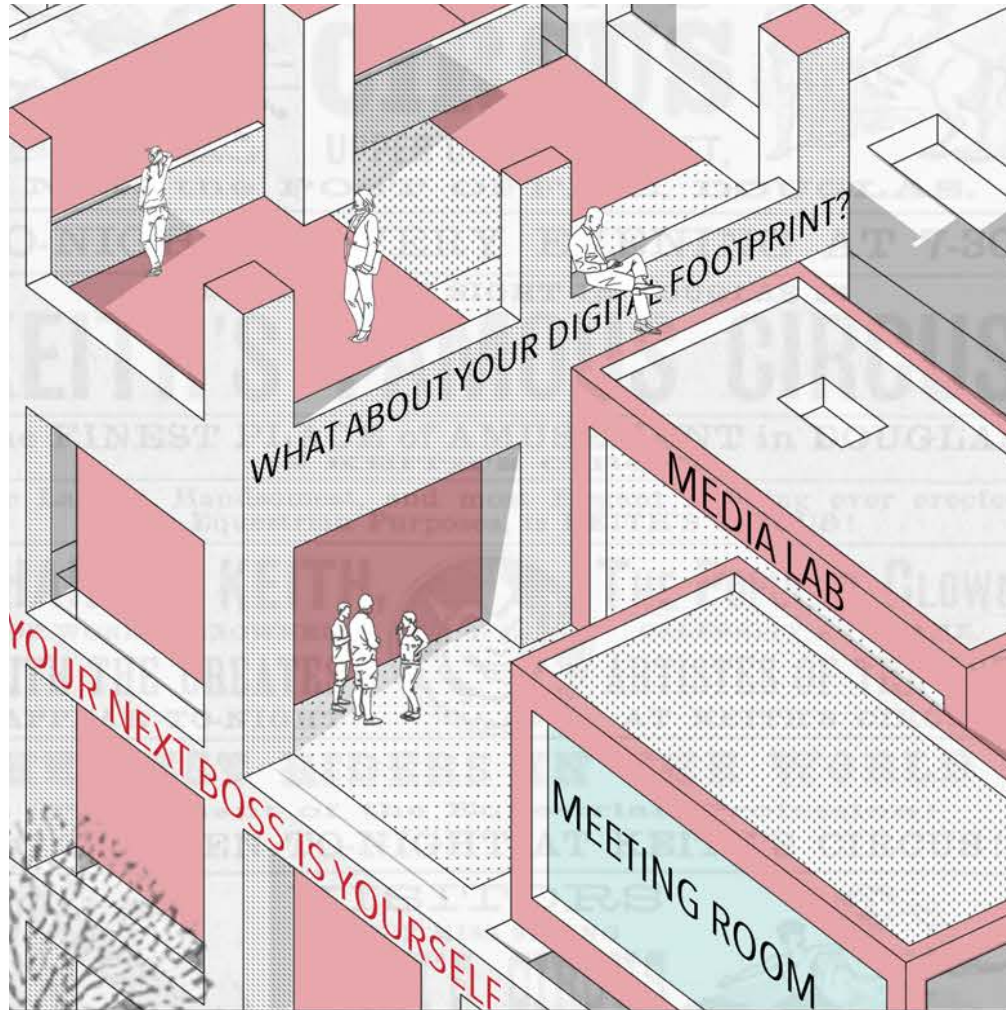

IDEA MARKET HEIDELBERG UNIVERSITY  
 THEATRE INNOVATION CENTRE  
 SHARED MEDIALAB  
 >>>  
 MEDIA START-UP CENTRE

PROTOTYPE CENTRE  
 KNOWLEDGE CENTRE HANDCRAFTS  
 ARTS CENTRE DEZERNAT 16  
 ARCHITECTURE SCHOOL  
 >>>

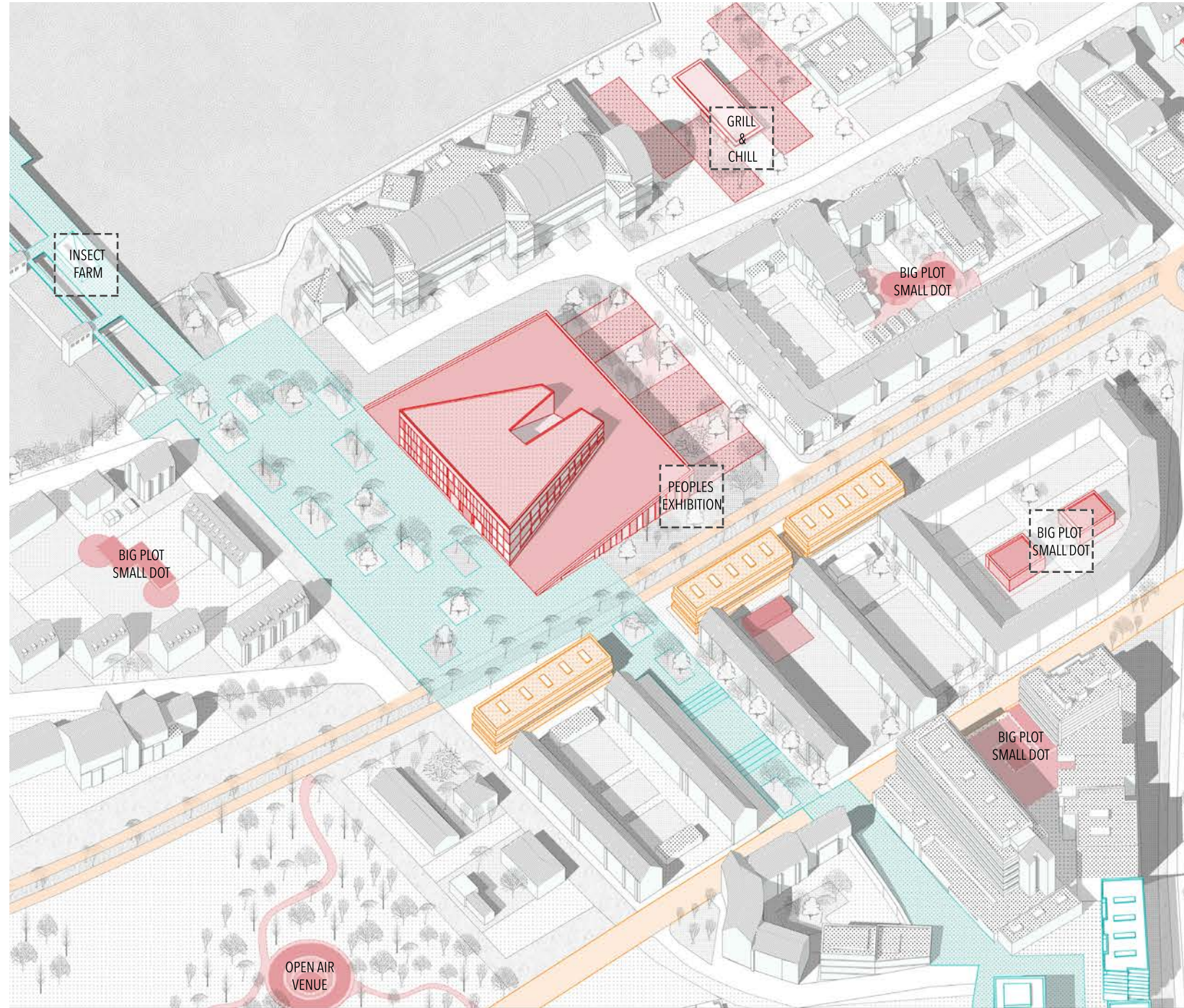

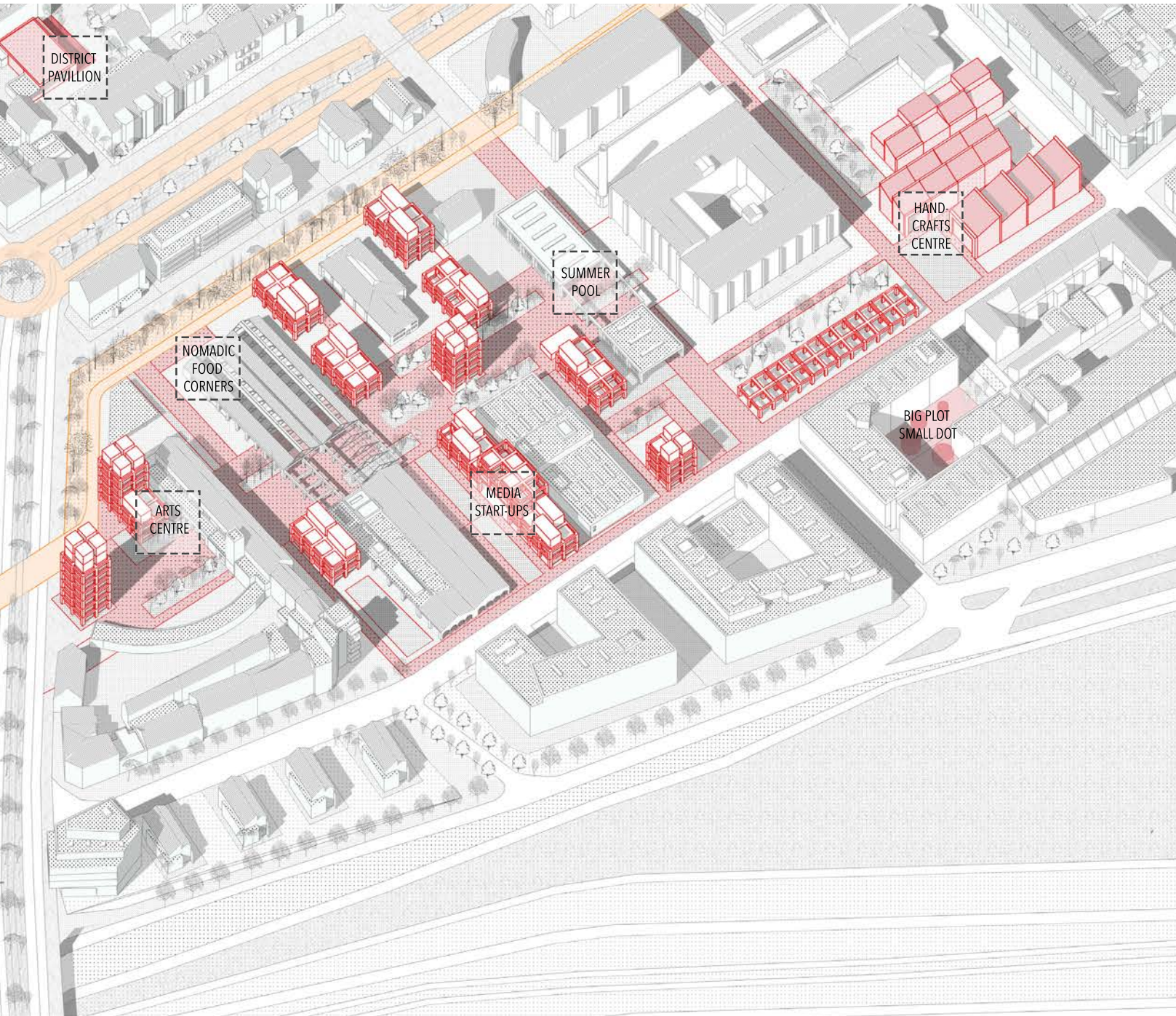





# MODELS

ABSTRACT REPRESENTATION OF PROPOSALS







